

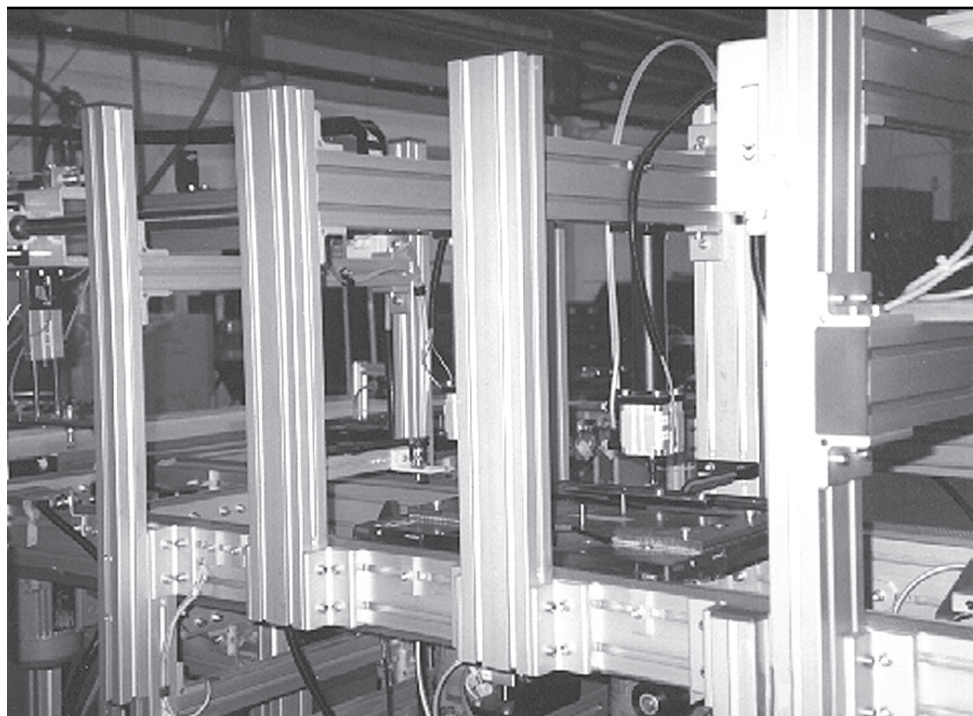

# Actec automation profiles

Anodized stock profiles for automation applications



**Purso Oy**  
Alumiinitie 1  
37200 Siuro

Puh. 03 3404 111

[purso@purso.fi](mailto:purso@purso.fi)  
[www.purso.fi](http://www.purso.fi)

# ACTEC AUTOMATION PROFILES by Purso

## Finnish expertise with 60 years of experience

The ACTEC aluminium profile range produced at Purso Oy's aluminium plant in Finland, comprises of all basic elements to make up functional structures. ACTEC aluminium profiles offer economical solutions for frameworks of working stations, shelters, conveyors, fixtures, special machinery and for other structures.

Purso offers Several alternative surface treatments such as anodizing and powder coating in order to strengthen and differentiate the surfaces according to the customer's needs. In addition, the profiles can be delivered cut to length. Due to the relatively short processing time from production to the end user, the ACTEC aluminium profiles range can be tailored to meet the special requirements of any applications. Originally, these profiles were developed to complement our manufacturing expertise, but with increasing demand they now form a separate group of products.

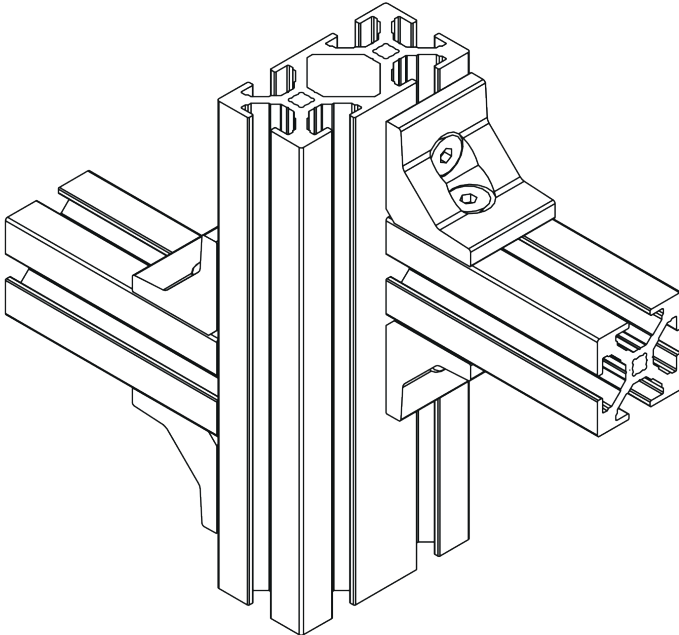

# ACTEC AUTOMATION PROFILES

## Frame profiles

J07394

**Dimensions: 30x30**

Light structures

Material: EN-AW 6063

m = 1.034 kg /m

Toler. DIN 17615

Wx = 2.33 cm<sup>3</sup>

Ix = 3.94 cm<sup>4</sup>

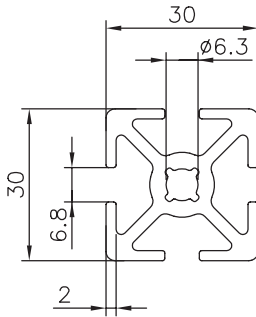

J11175

**Dimensions: 40x40**

Light structures

Material: EN-AW 6063

m = 1.914 kg /m

Toler. DIN 17615

Wx = 5.88 cm<sup>3</sup>

Ix = 11.73 cm<sup>4</sup>

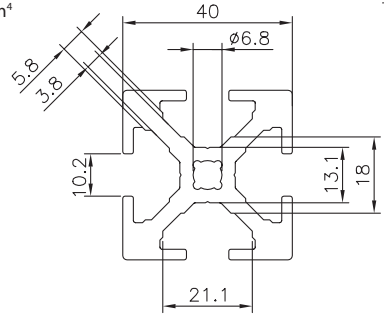

J10659

**Dimensions: 50x50**

Light Structures

Material: EN-AW 6063

m = 1.747 kg /m

Toler. DIN 1748

Wx = 6.56 cm<sup>3</sup>

Ix = 16.39 cm<sup>4</sup>

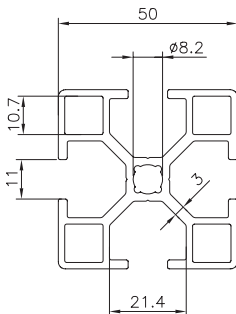

J06770

**Dimensions: 50x50**

Heavy structures

Material: EN-AW 6063

m = 2.711 kg /m

Toler. DIN 17615

Wx = 10.7 cm<sup>3</sup>

Ix = 26.8 cm<sup>4</sup>

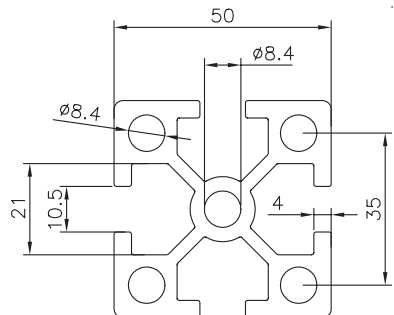

# ACTEC AUTOMATION PROFILES

## Frame profiles

J12216

**Dimensions: 40x80**

Heavy structures

Material: EN-AW 6063

m = 3.445 kg / m

Toler. DIN 17615

Wx = 10.9 cm<sup>3</sup>

Wy = 20.0 cm<sup>3</sup>

Ix = 21.8 cm<sup>4</sup>

Iy = 80.0 cm<sup>4</sup>

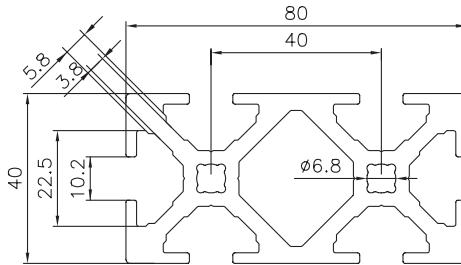

J06771

**Dimensions: 50x100**

Heavy structures

Material: EN-AW 6063

m = 4.390 kg / m

Toler. DIN 17615

Wx = 18.2 cm<sup>3</sup>

Wy = 35.3 cm<sup>3</sup>

Ix = 45.9 cm<sup>4</sup>

Iy = 176.7 cm<sup>4</sup>

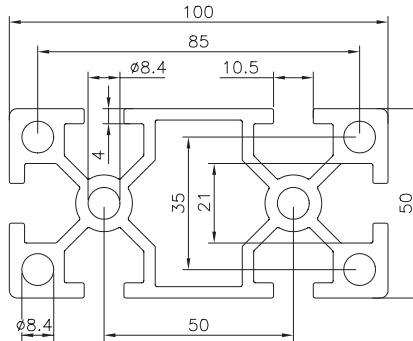

J11594

**Dimensions: 80x80**

Heavy structures

Material: EN-AW 6063

m = 5.303 kg / m

Toler. DIN 1748

Wx = 35.78 cm<sup>3</sup>

Ix = 143.13 cm<sup>4</sup>

