

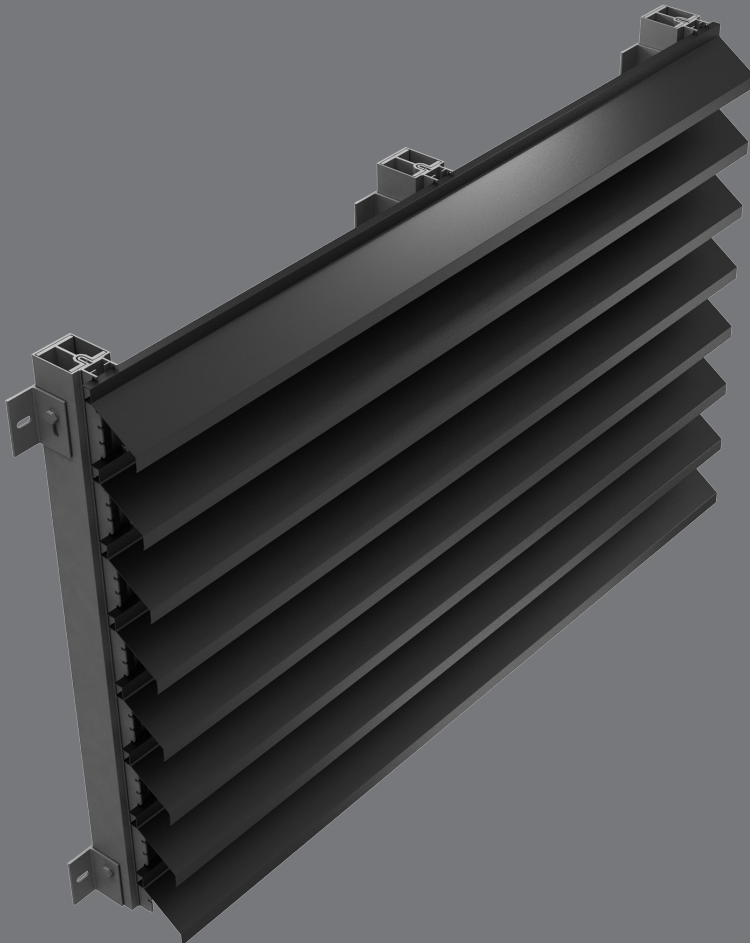

NAPSU -sälejärjestelmä Muut säleet Paneelijärjestelmä ALLINE -sisäkatto

NAPSU -lamella system
Other lamellas
Panel system
ALLINE -ceiling



Purso Oy vastaa tämän tuotekatalogin sovellustapojen toimivuudesta, mutta muista sovellustavoista vain erikseen sovittaessa. Vastuu rakenteiden valmistuksen ja asennuksen valvonnasta ei kuulu Purso Oy:lle.

Purso Oy quarantees the function of the applications described in this catalogue. Other applications are quaranteed only by separate agreement. Purso Oy does not take responsibility for control of the installations.

**SISÄLLYS
CONTENTS**

NAPSU -sälejärjestelmä NAPSU -lamella system	1
Muut säleet Other lamellas	2
Paneelijärjestelmä Panel system	3
ALLINE -sisäkatto ALLINE -ceiling	4

NAPSU -sälejärjestelmä
 NAPSU -lamella system

NAPSU KAMPAKIINNITYSPROFIILI (P-22284) K2254
 NAPSU MOUNTING PROFILE (P-22284) K2254

varastopituus 6100 mm / storage length 6100 mm

nettopituus 5960 mm / net length 5960 mm

HUOM! Tarvittaessa lämpötilavaihtelut ja lämpöliikevarat on huomioitava, suositeltava käyttöpituus 3000 mm, kun lämpötilan vaihtelu $\Delta T \geq 100^\circ\text{C}$

ATTENTION! If necessary thermal expansion should be taken into account, recommended operating length is 3000 mm for temperature variations $\Delta T \geq 100^\circ\text{C}$

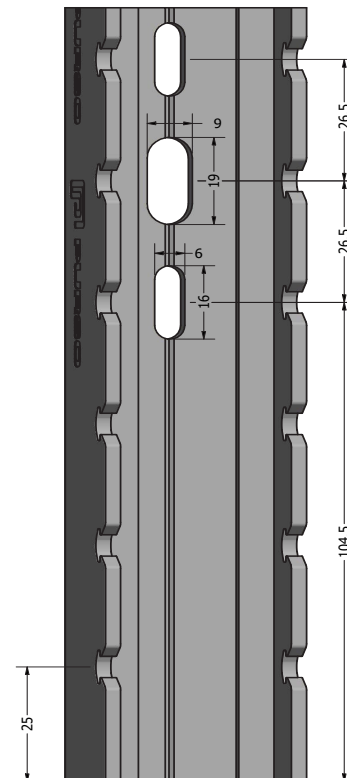
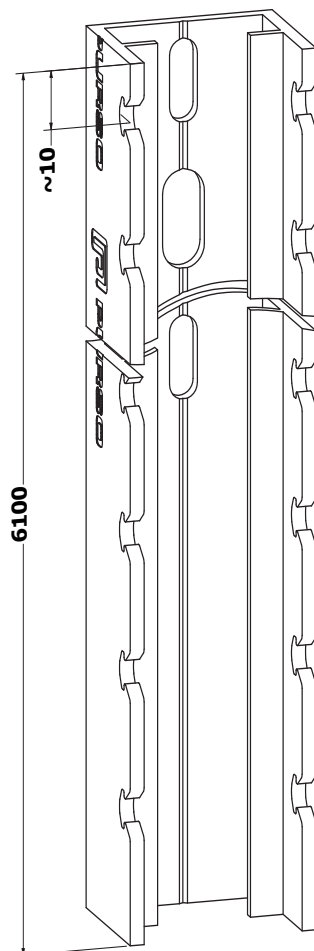

Kiinnityskampa tarvitsee apurungon.
 Max. kiinnitysväli 424 mm.

The mounting profile requires a supporting structure.
 The maximum mounting distance is 424 mm.

NAPSU -sälejärjestelmä
NAPSU -lamella system

Kampaprofilin kiinnitysruuvi 4,8 × 25 AISI 304/A2
Fastening screw for mounting profiles 4.8 × 25 AISI 304/A2

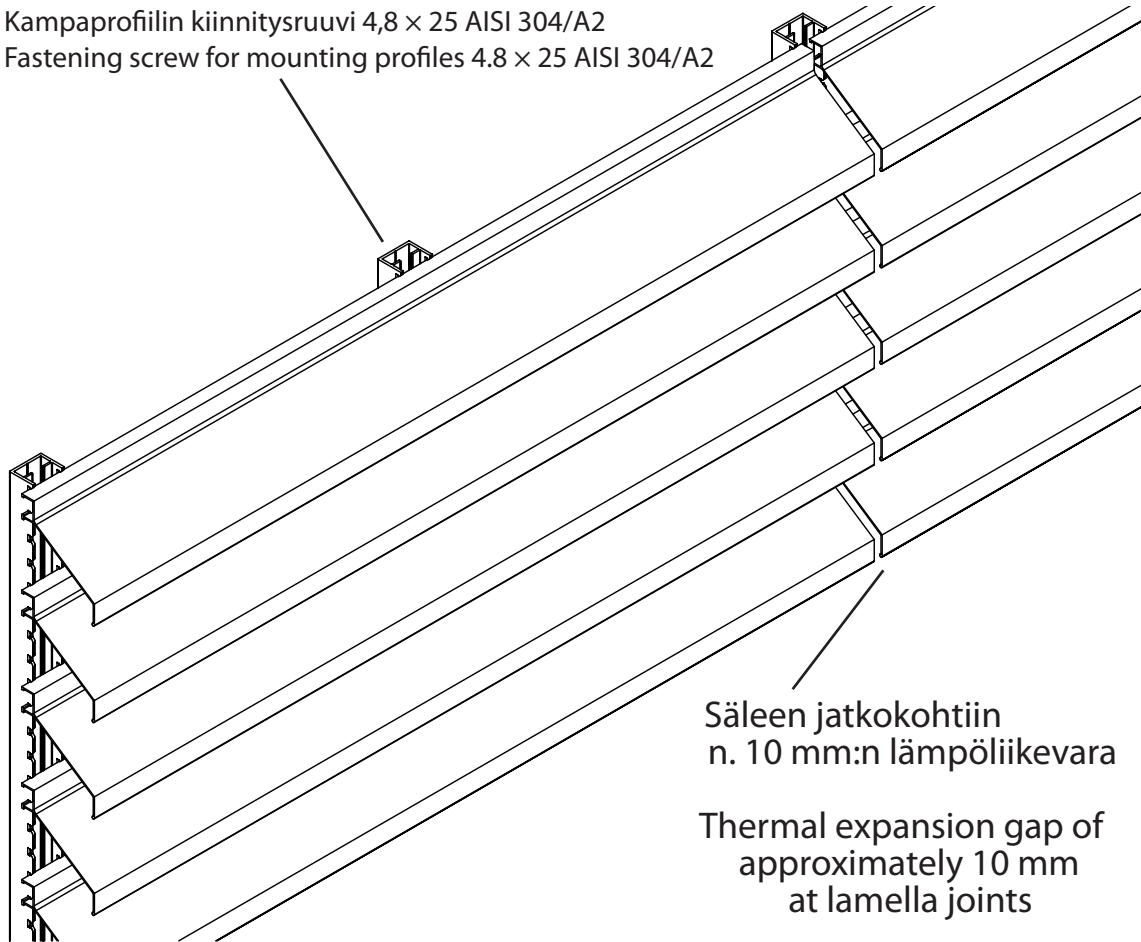

Säleen uppouma kampaan 6mm

Lamella insertion depth 6mm

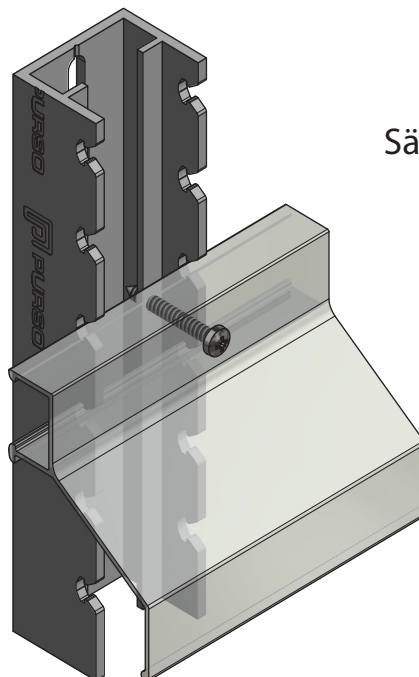

KIINNITYSKAMMASSA LAIPAT RUUVIKIINNITYSTÄ VARTEN
MOUNTING PROFILE ENABLES SET SCREW ATTACHMENT

NAPSU säleet
NAPSU lamellas

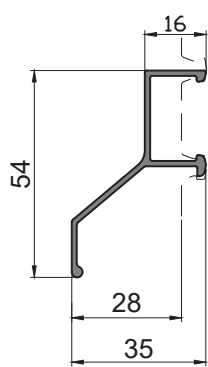

P-19109

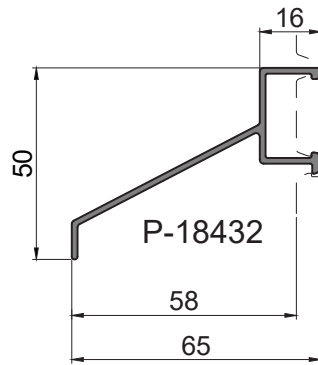

P-18432

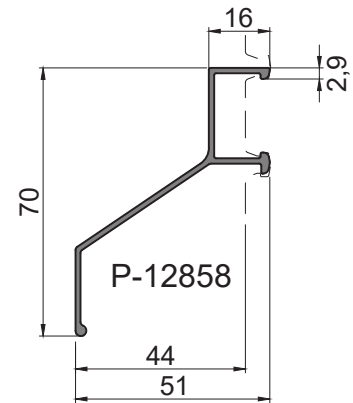

P-12858

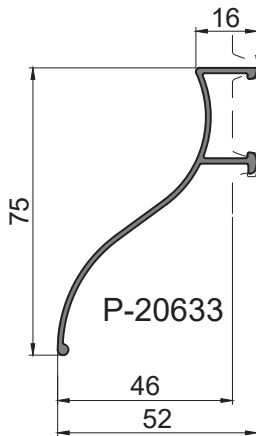

P-20633

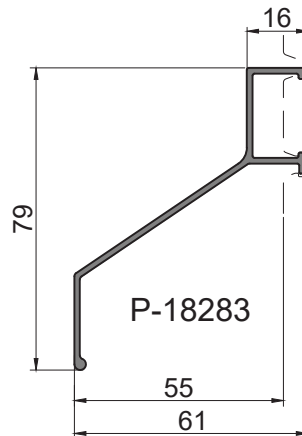

P-18283

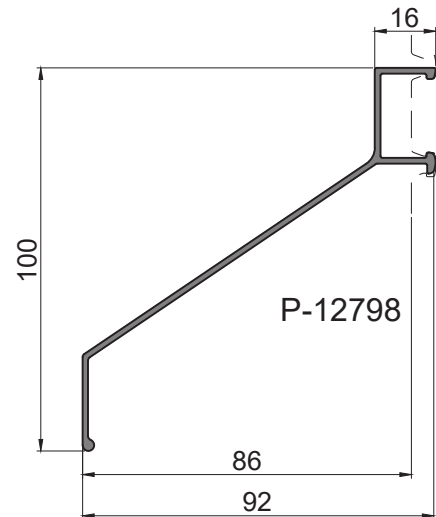

P-12798

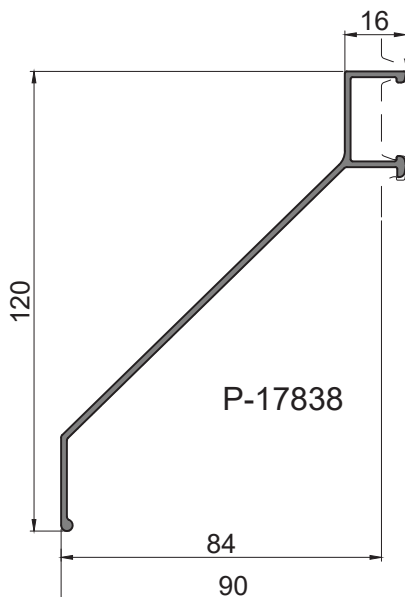

P-17838

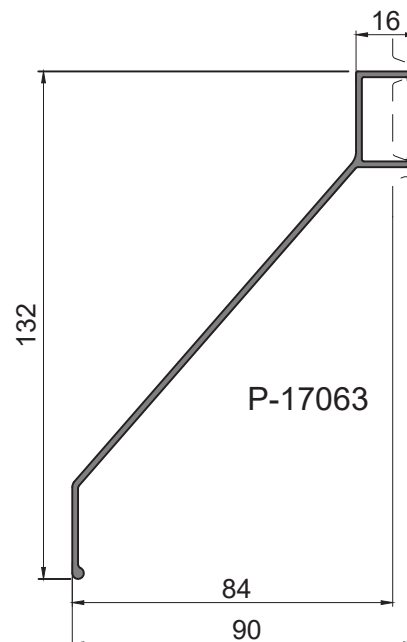

P-17063

NAPSU säleet
NAPSU lamellas

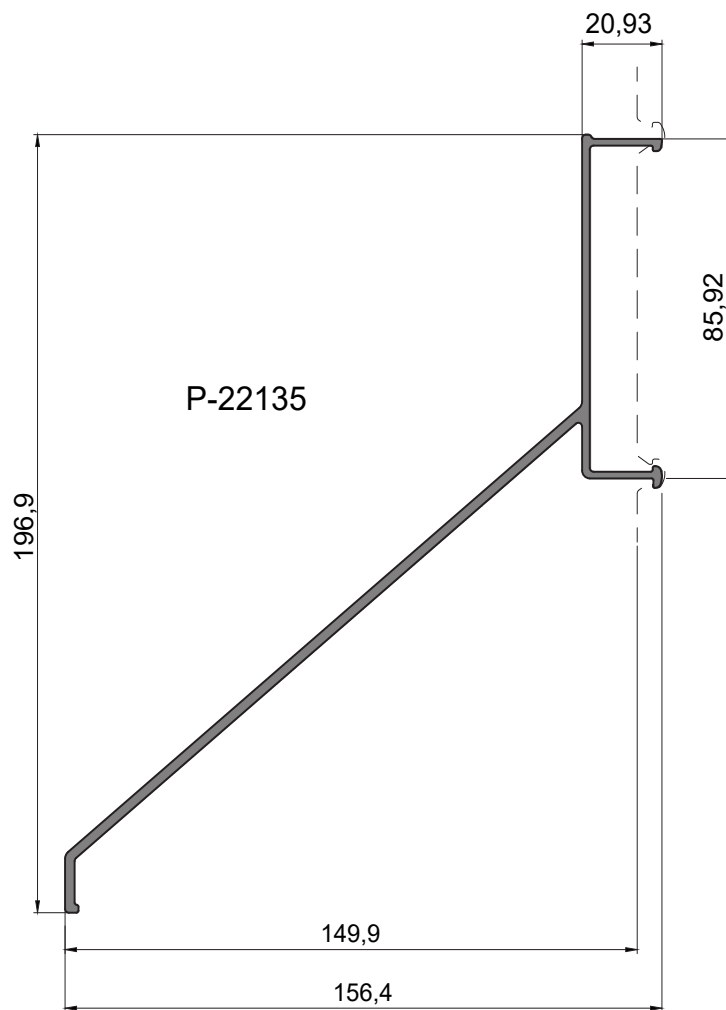
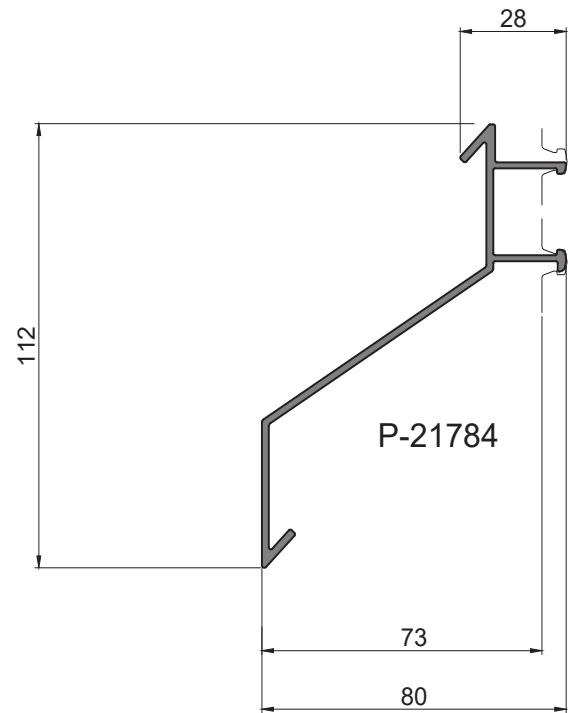
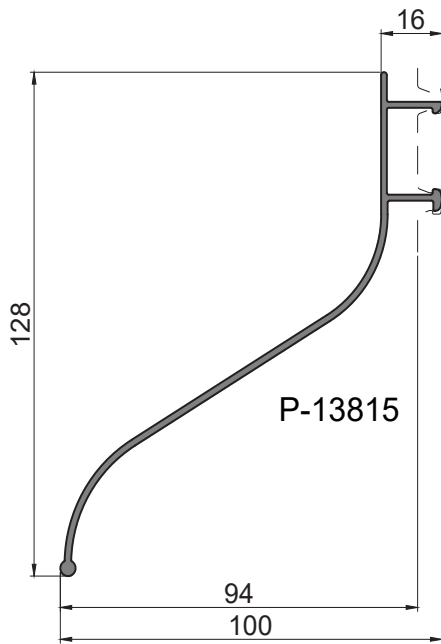

P-22135 säleprofiili vaatii vakiosta c/c poikkeavan NAPSU -asennuskampa profiilin
P-22135 lamella profile need special c/c NAPSU -mounting profile

NAPSU säleet
NAPSU lamellas

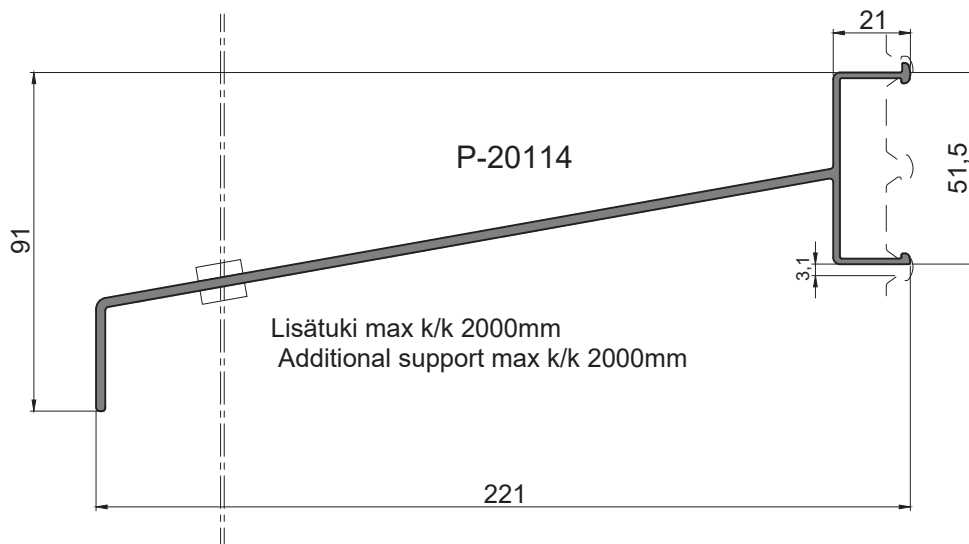
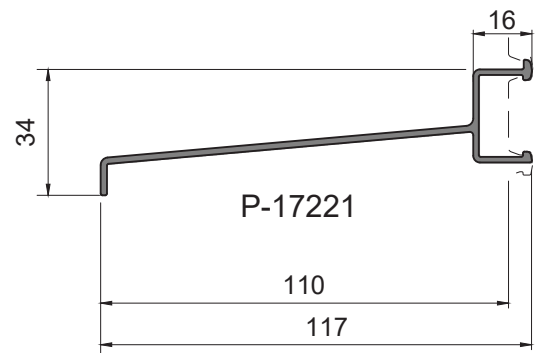
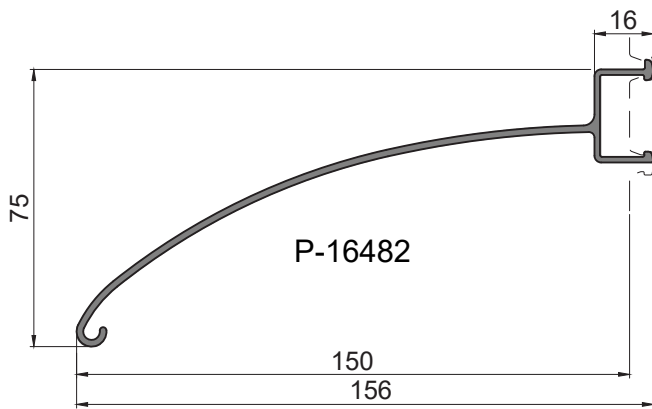

NAPSU säleet
NAPSU lamellas

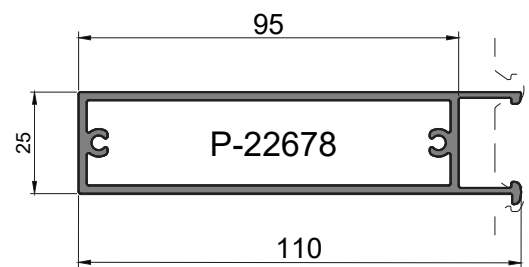
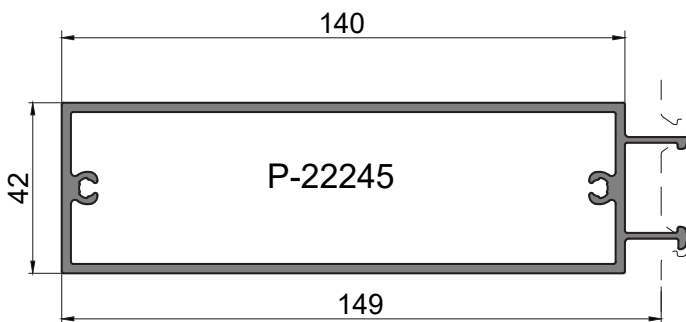
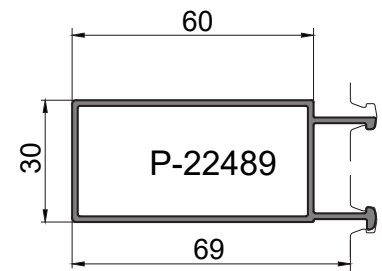
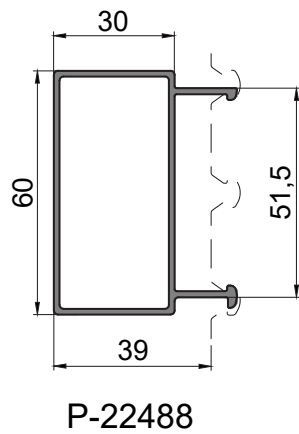
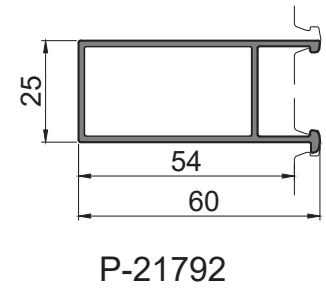
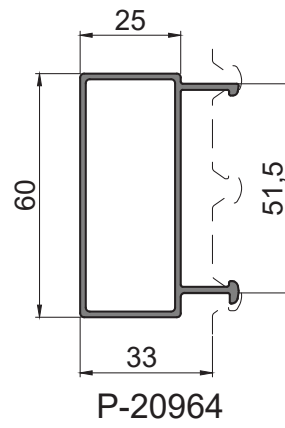
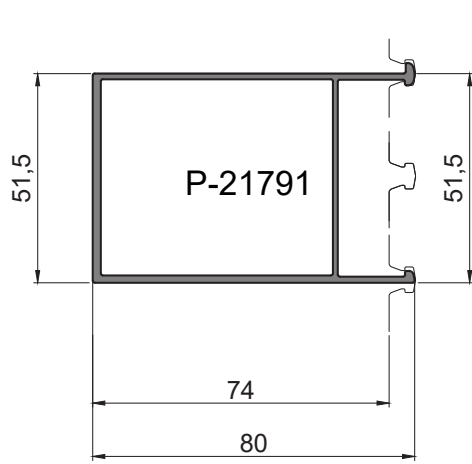

P-22245 ja P-22678 vain pystyasennukseen
P-22245 and P-22678 for vertical installation only

NAPSU säleet
NAPSU lamellas

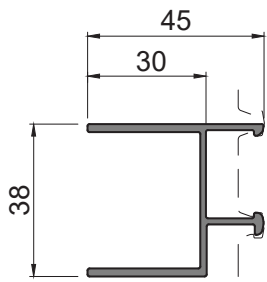

P-15843

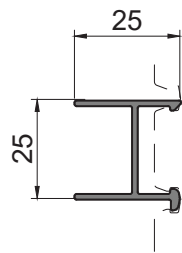

P-16878

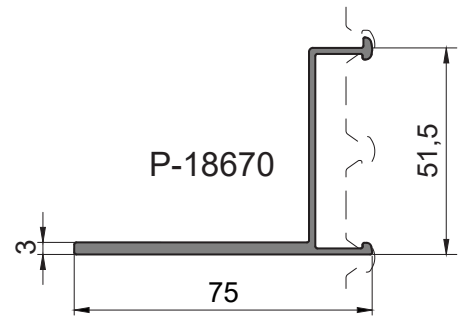

P-18670

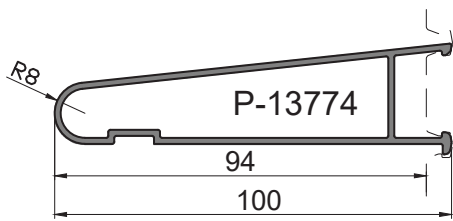

P-13774

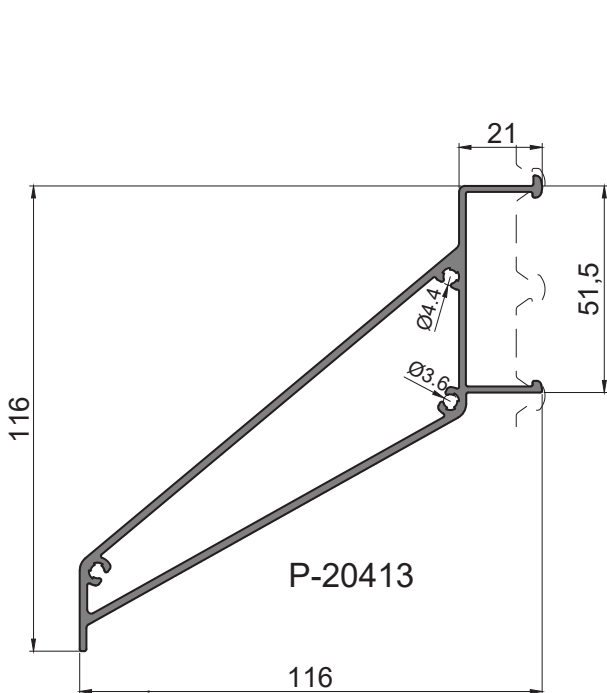

P-20413

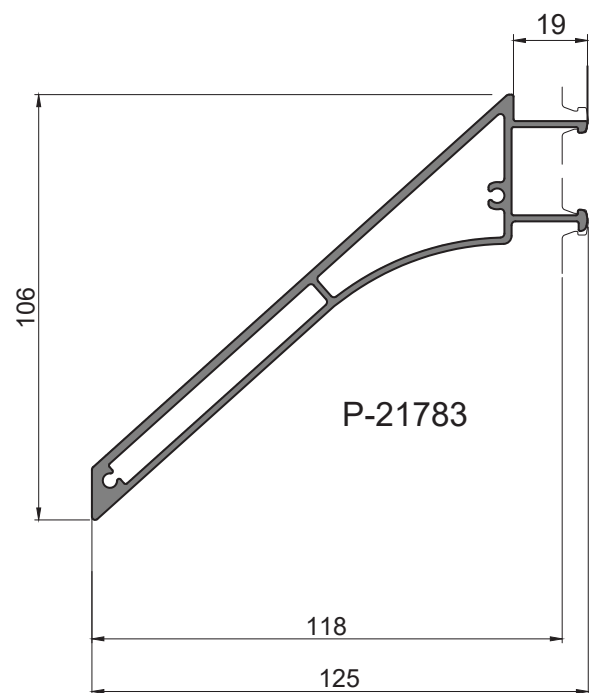

P-21783

NAPSU säleet
NAPSU lamellas

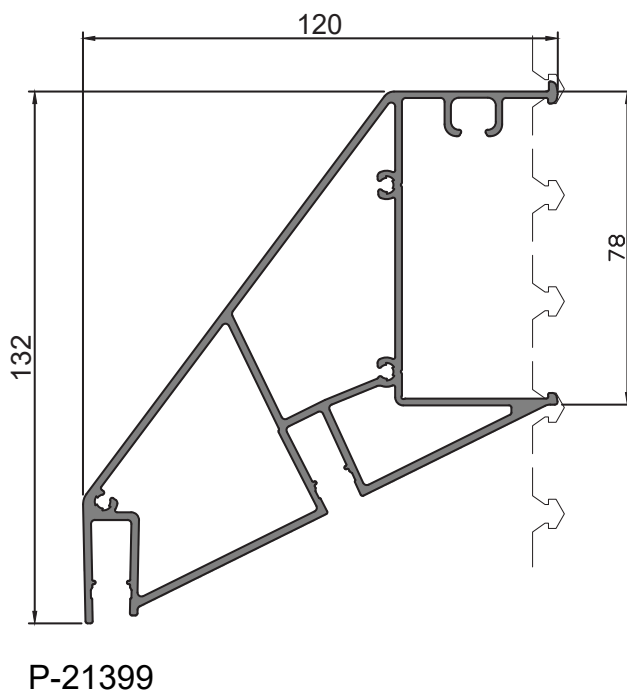
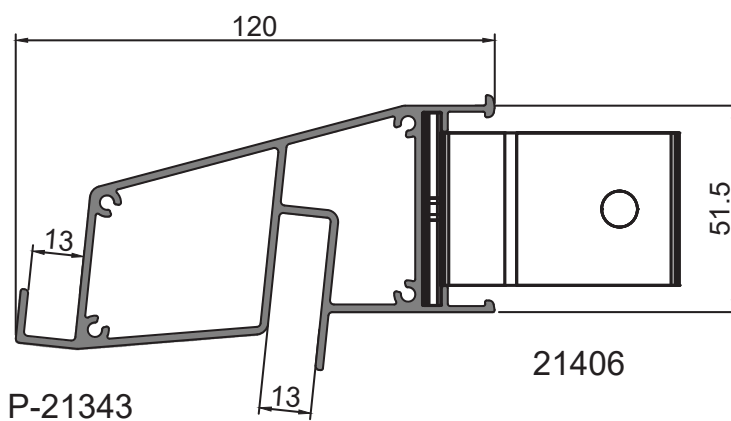
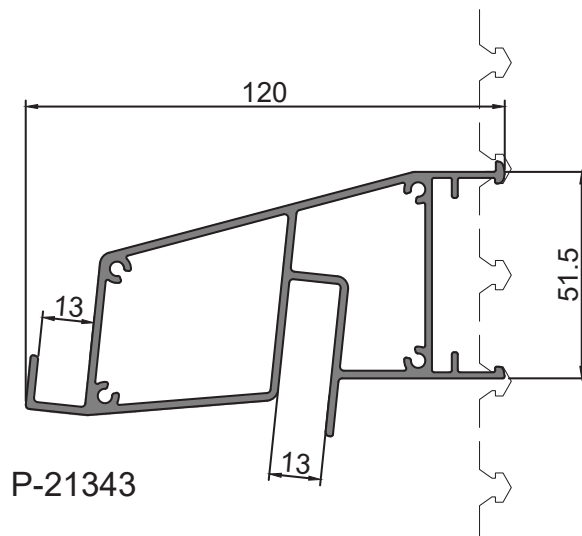

NAPSU säleet
NAPSU lamellas

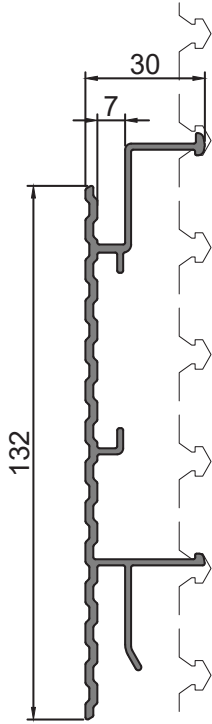

P-21389

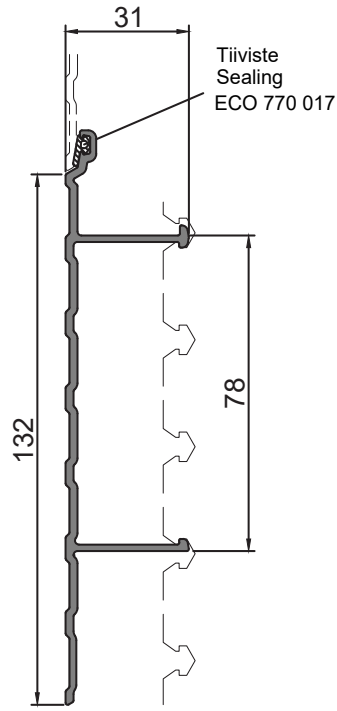

P-21261

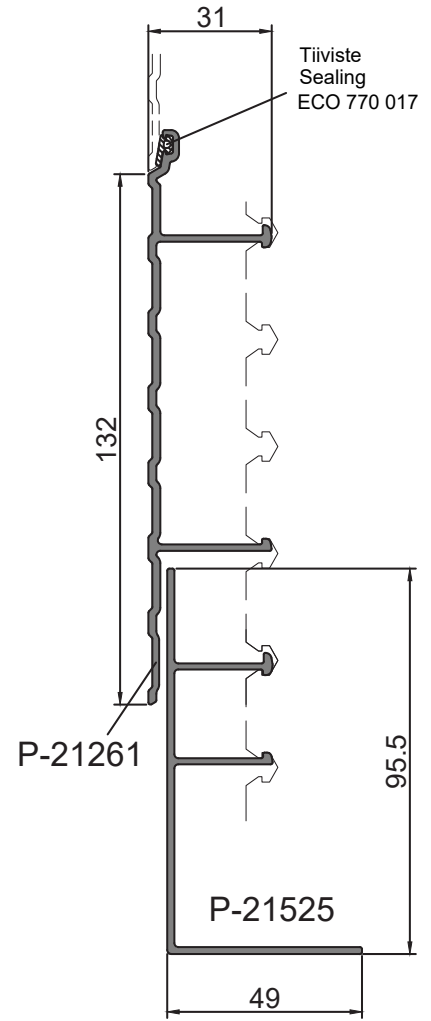

P-21525

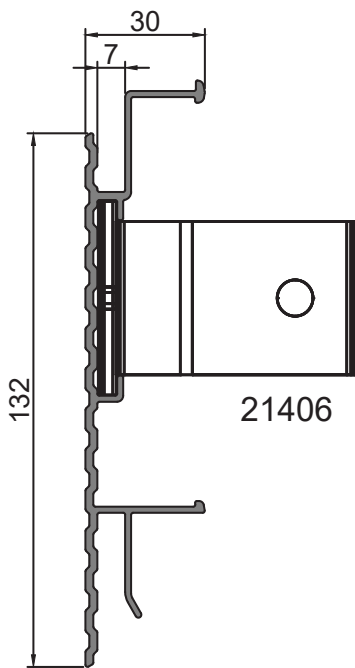

P-21389

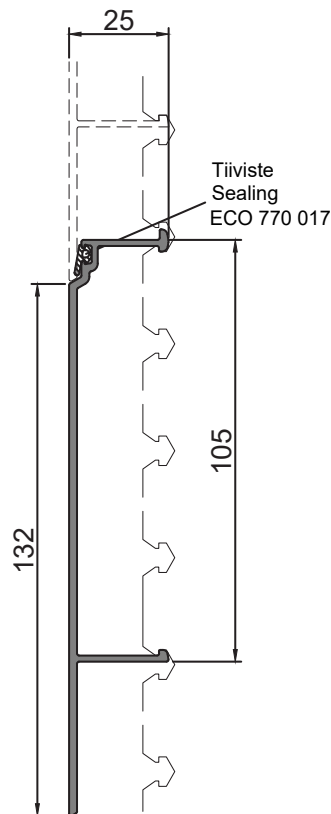

P-21086

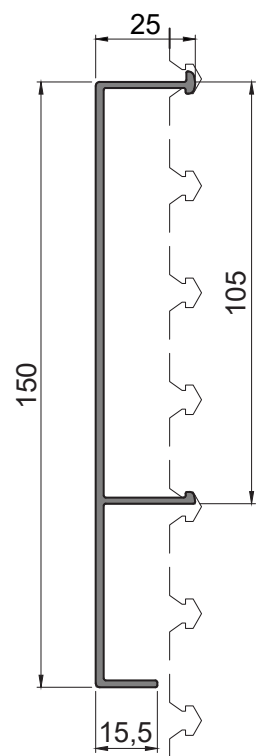

P-20696

NAPSU säleet
NAPSU lamellas

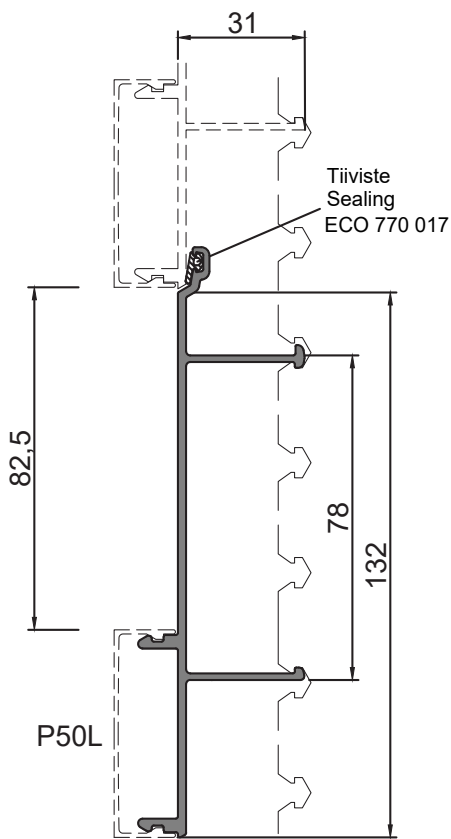

P-21629

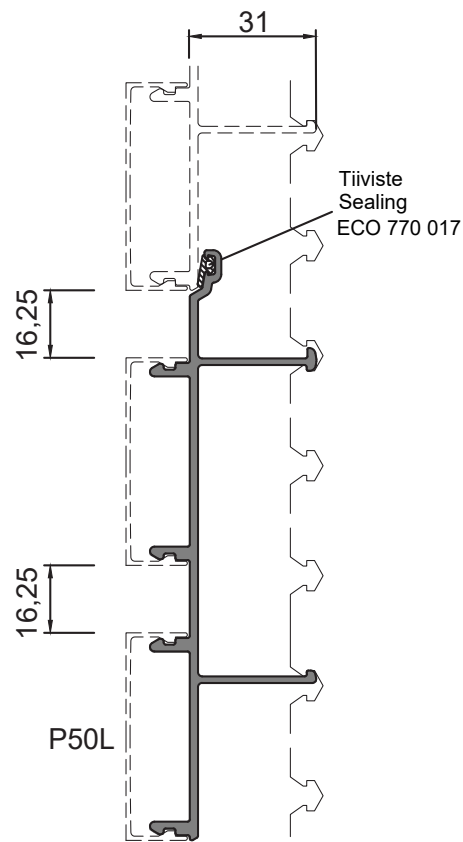

P-22405

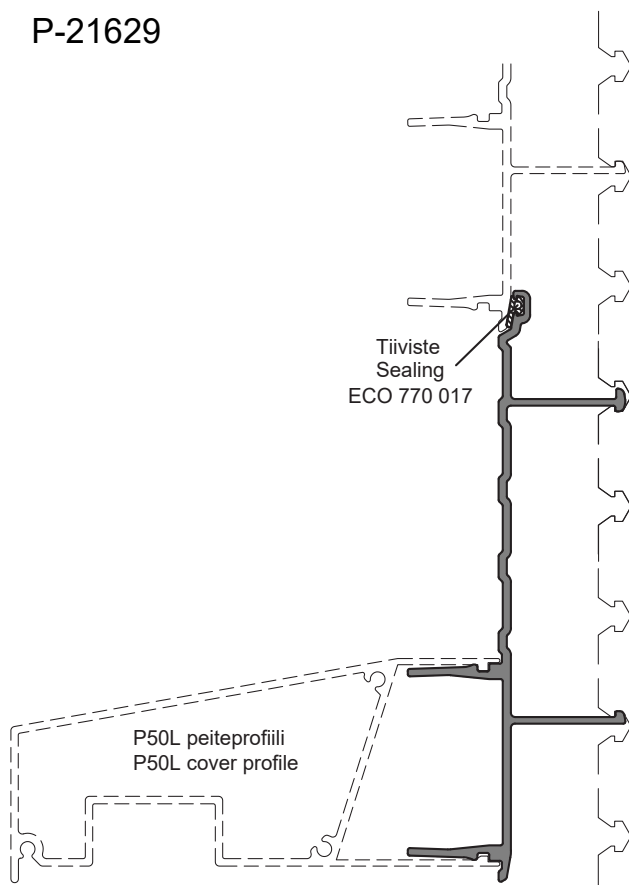

P-21400

NAPSU WOOD säleet
NAPSU WOOD lamellas

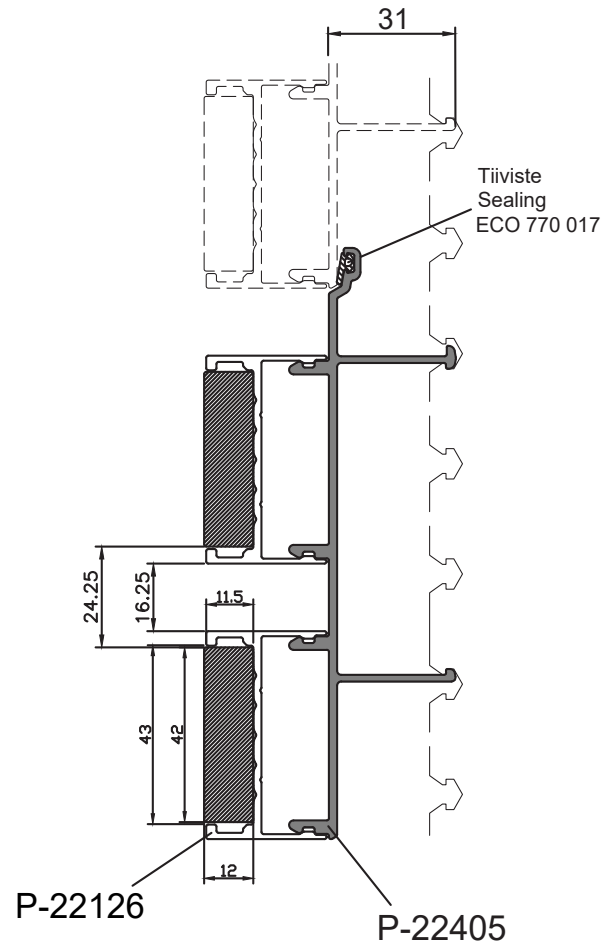
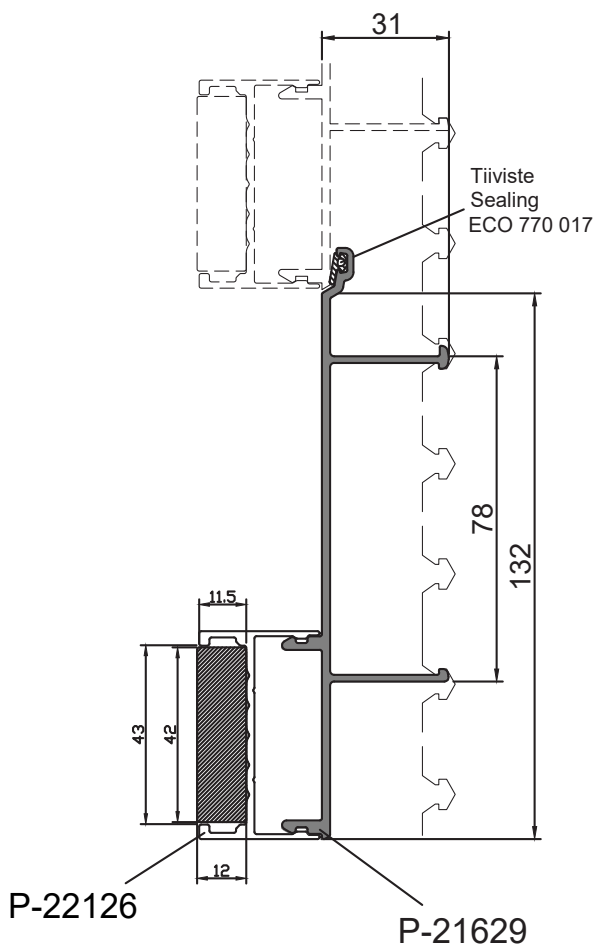

NAPSU -aita profilit
NAPSU -fence profiles

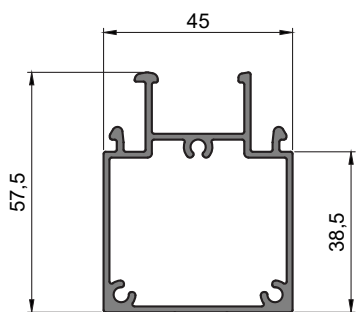

P-22066

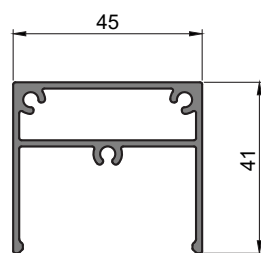

P-22067

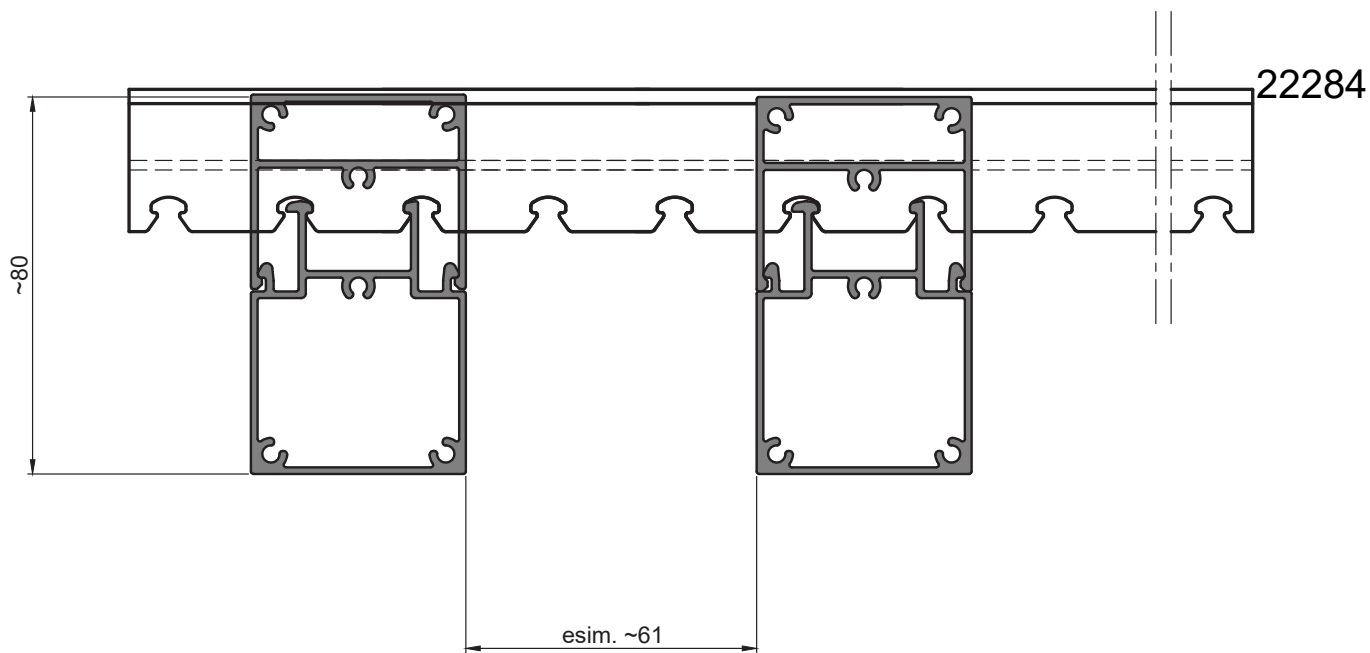

Kehikko profiili
Frame profile

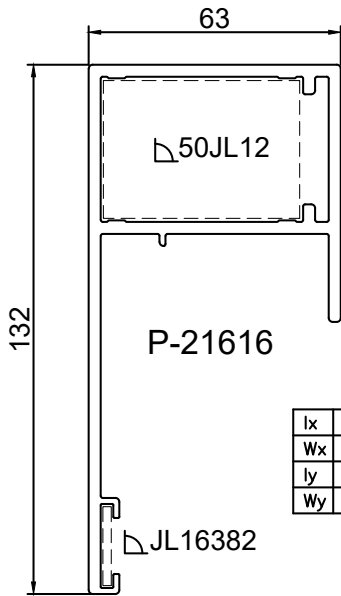

ix	134.44 cm ⁴
Wx	15.18 cm ³
ly	61.86 cm ⁴
Wy	16.39 cm ³

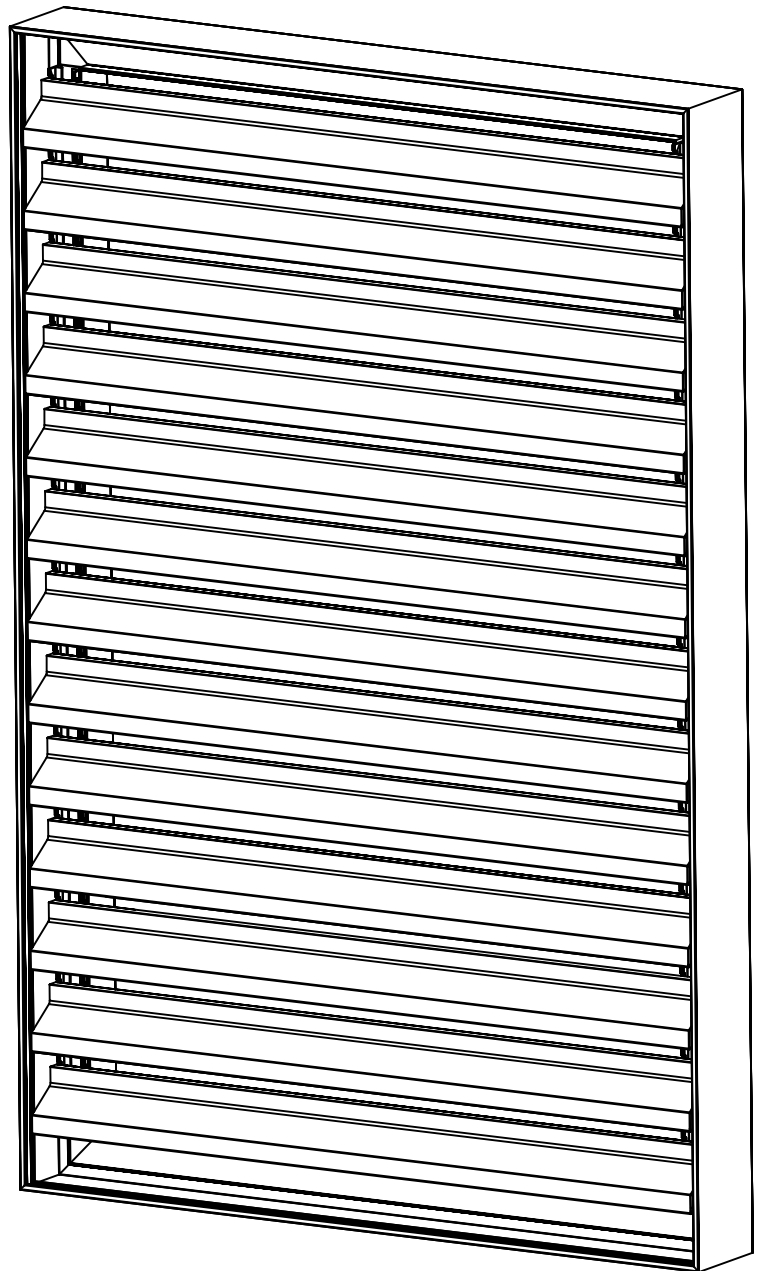
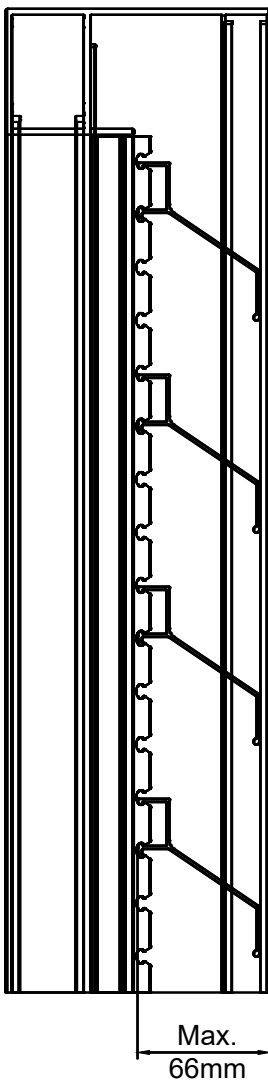

NAPSU KIINNITYSPALAT
NAPSU MOUNTING PIECES

PYSTYSÄLEIKKÖ
Vertical louvre systems

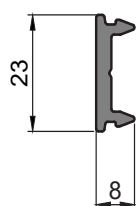

P-12799
L=30..40 mm

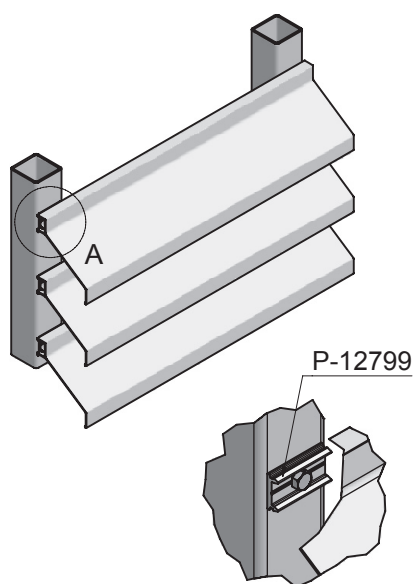

VAAKASÄLEIKKÖ
Horizontal louvre systems

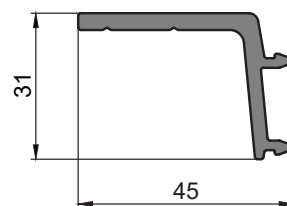

P-12860
L=30..40 mm

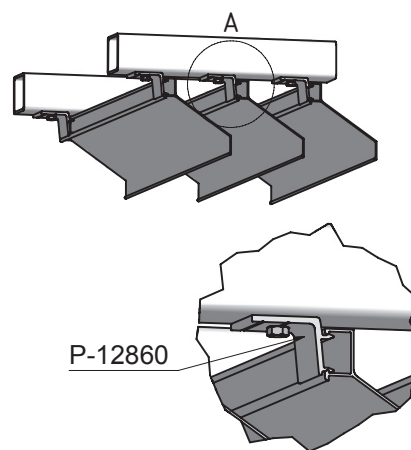

**NAPSU SÄLEEN KINNITYS
NAPSU LAMELL MOUNTING**

Fixplate kiinnitys
Fixplate installation

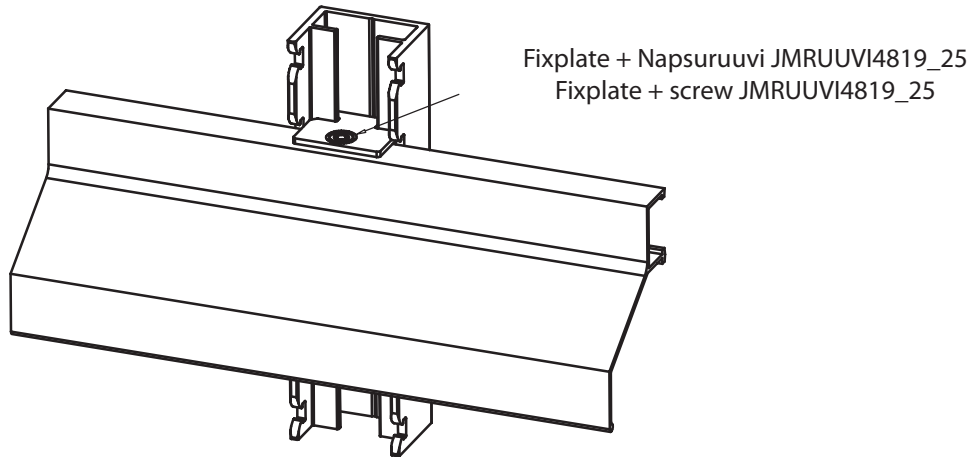

Fixplate kiinnitystä käytettäessä jokaiseen kiinnityskohtaan tulee Fixplate+Napsuruuvi s. 1.8.1-1.8.2
Suositellut jännevälit kiinnityskohdille sivuilla 2.2.1-2.2.2

When using Fixplate installation, each attachment point should have Fixplate+Napsuruuvi pp. 1.8.1-1.8.2
Recommended spans for mounting points on pages 2.2.1-2.2.2

Ruuvikiinnitys
Installation with screws

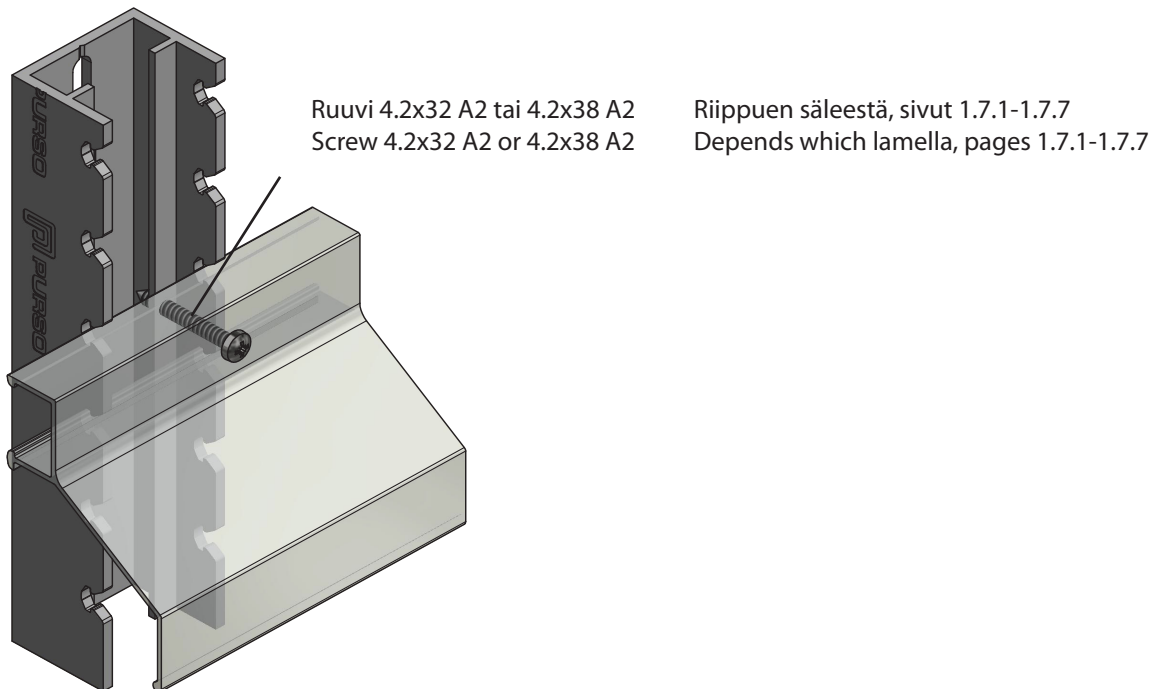

Jokaisessa kiinnityskohdassa tulee olla Fixplate kiinnitys tai Ruuvikiinnitys.
Each attachment point should have Fixplate installation or screw mounting.

NAPSU APURUNGOT JA KIINNITYSKORVAKKEET
NAPSU ASSEMBLY PROFILES AND MOUNTING BRACKETS

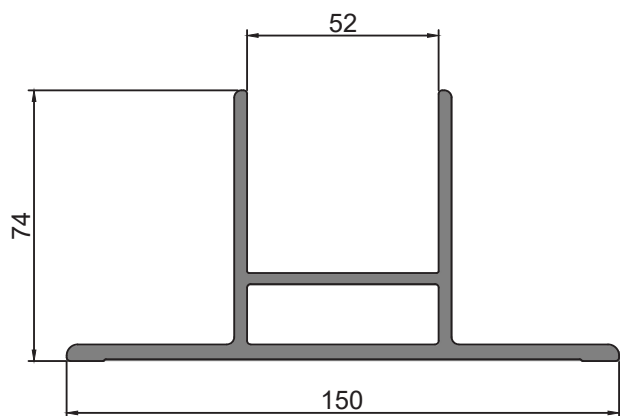

P-21406

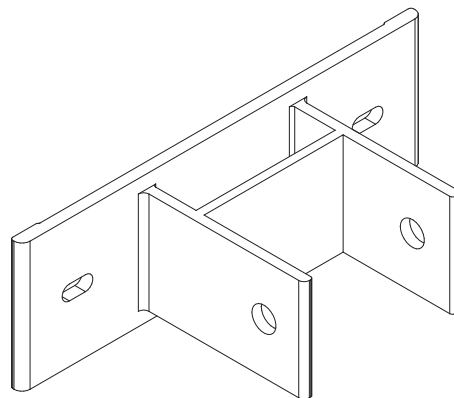

P50L peitelista
P50L cover strip

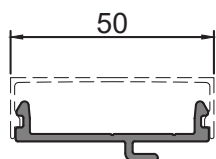

P-21455

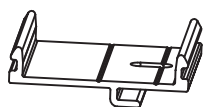

K2127

NAPSU APURUNGOT JA KIINNITYSKORVAKKEET
 NAPSU ASSEMBLY PROFILES AND MOUNTING BRACKETS

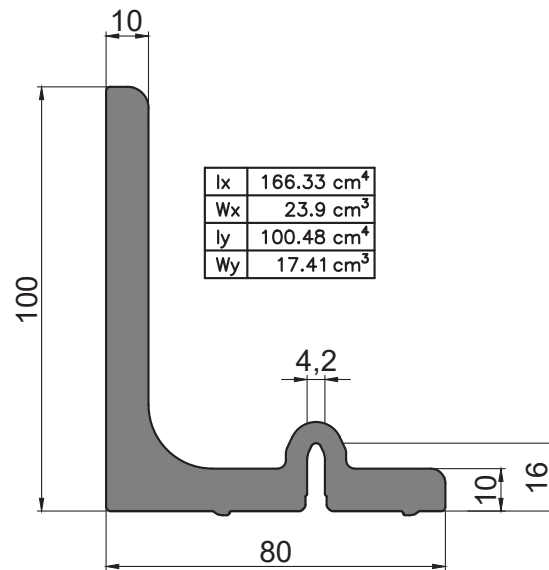

P-20412

Kiinnityskorvake kiinnitetään tukevasti esimerkiksi rakennusrungosta ulkonevaan lattaan

Mounting brackets are fixed securely for example to a flat bar projectin out from building frame

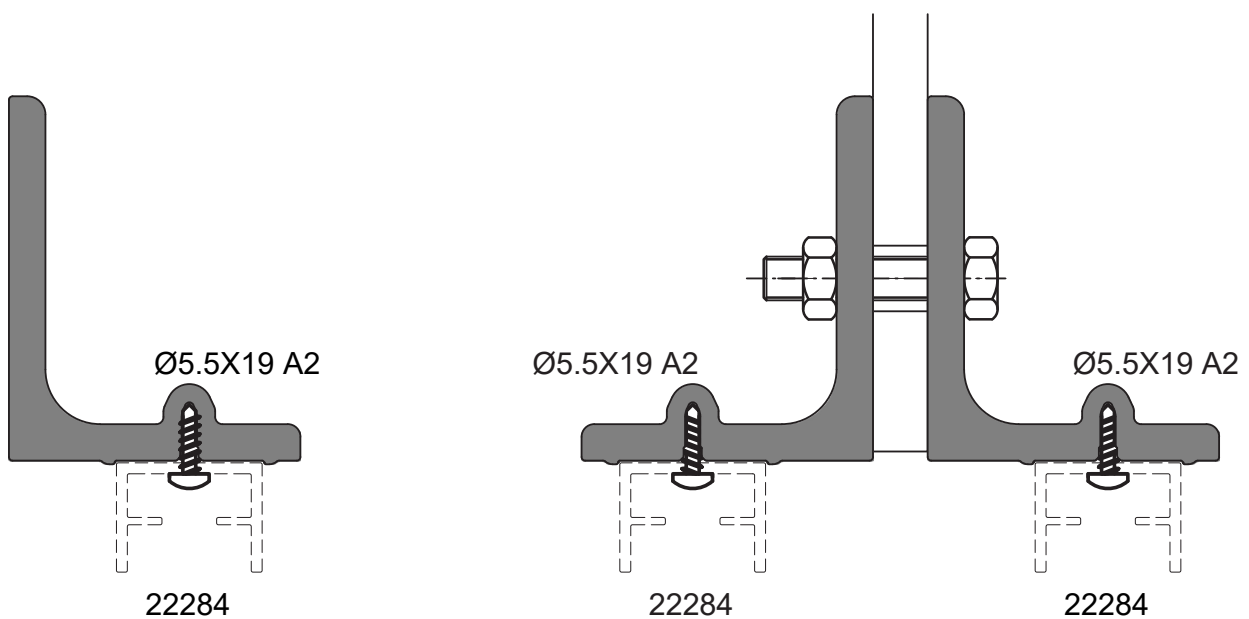

NAPSU APURUNGOT JA KIINNITYSKORVAKKEET
 NAPSU ASSEMBLY PROFILES AND MOUNTING BRACKETS

Kiinnityskorvakkeet
 Mounting brackets

Runkoprofiili
 Frame profile

I _x	43.12 cm ⁴
W _x	11.75 cm ³
I _y	20.80 cm ⁴
W _y	8.32 cm ³

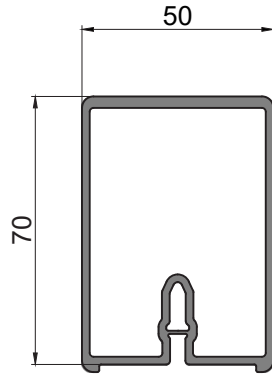

P-17839

Jäykisteprofiili
 Reinforcement profile

I _x	38.02 cm ⁴
W _x	11.55 cm ³
I _y	7.60 cm ⁴
W _y	3.46 cm ³

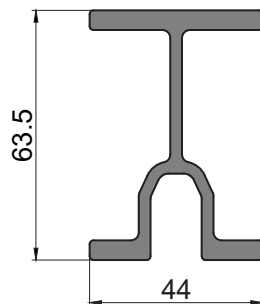

P-17840

Runkoprofiili
 Frame profile

I _x	86.73 cm ⁴
W _x	20.46 cm ³
I _y	53.35 cm ⁴
W _y	15.24 cm ³

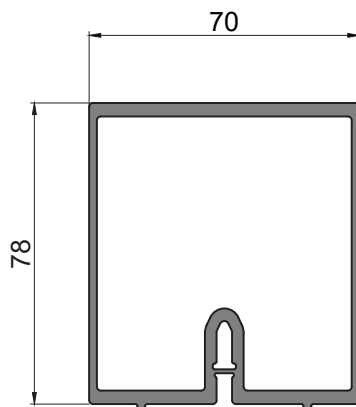

P-17061

Jäykisteprofiili
 Reinforcement profile

I _x	78.37 cm ⁴
W _x	22.16 cm ³
I _y	26.20 cm ⁴
W _y	8.27 cm ³

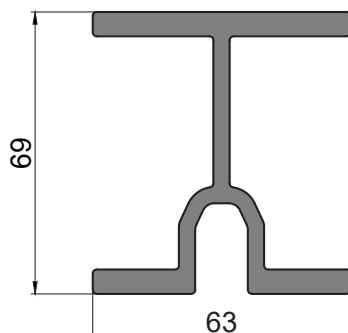

P-17222

YLÄ- JA ALAKIINNIKE
 TOP AND BOTTOM BRACKETS
 17841/ K2081

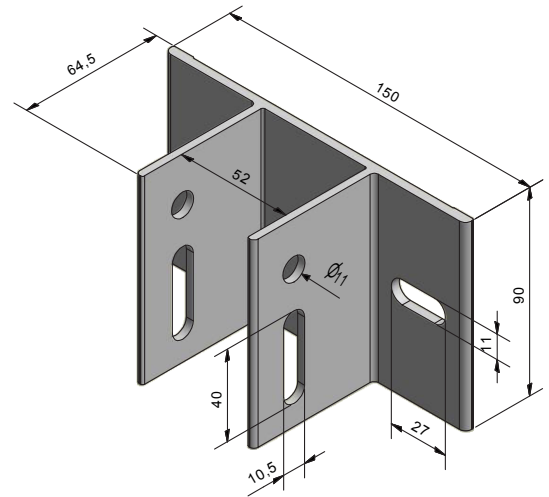

YLÄ- JA ALAKIINNIKE
 TOP AND BOTTOM BRACKETS
 17062/ K2082

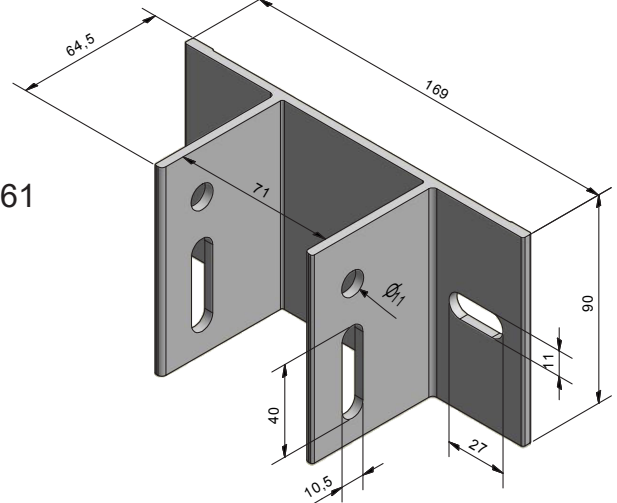

**ASENNUSJÄRJESTYS
INSTALLATION ORDER**

- 1.** Asennetaan ja kiinnitetään kiinnityskorvakkeet taustarakenteeseen. NAPSU apurunkoprofiili pultataan paikalleen. Jäykisteprofiili sisään tarvittaessa.

Install the mounting brackets. Bolt the NAPSU frame profile into place. Insert the reinforcement profile, if necessary.

- 2.** NAPSU kampakiinnitysprofili kiinnitetään ruuveilla NAPSU apurunkoon. Install NAPSU mounting profile with screws to the NAPSU frame profile.

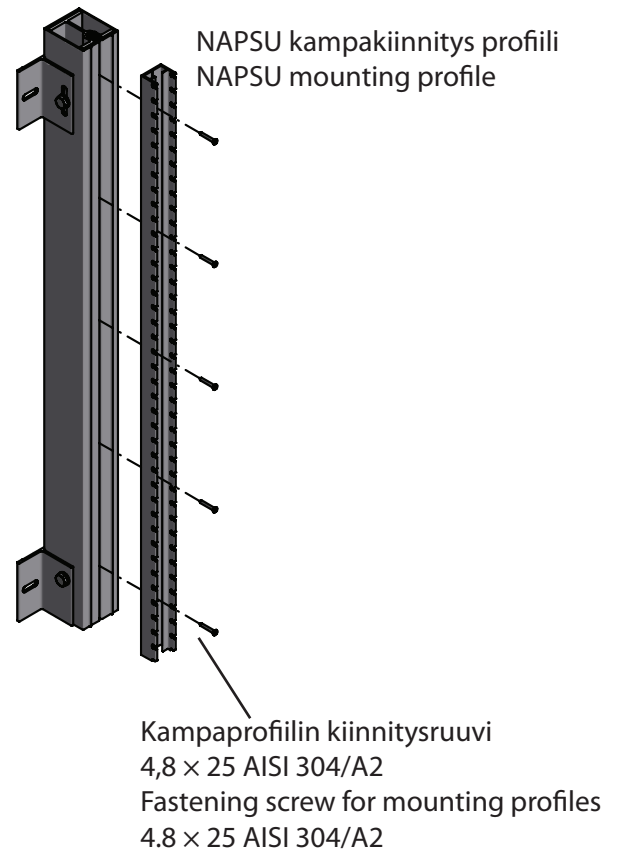
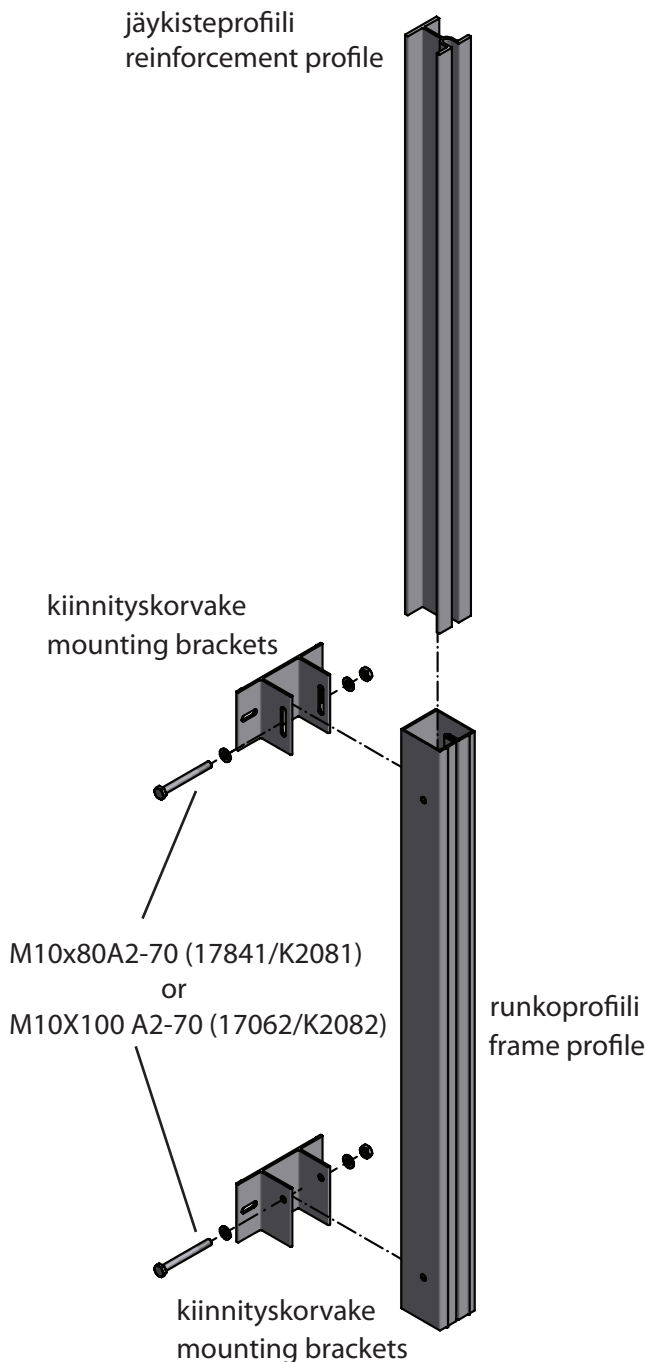

**AENNUSJÄRJESTYS
INSTALLATION ORDER**

- 3.** Asenna NAPSU säleet, säleiden asennussuunta huomioitava, kts. sivut 1.7.1-1.7.7
install the NAPSU lamellas. Direction of the installation must noticed, see pages 1.7.1-1.7.7

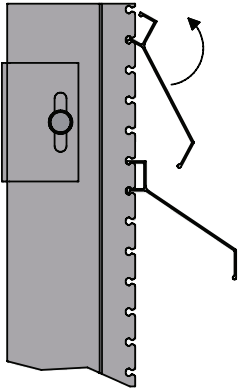

- 4.** Fixplate kiinnitys (tai ruuvikiinnitys) joka kiinnityskohtaan.
Fixplate installation (or installation with screws) to every attachment point.

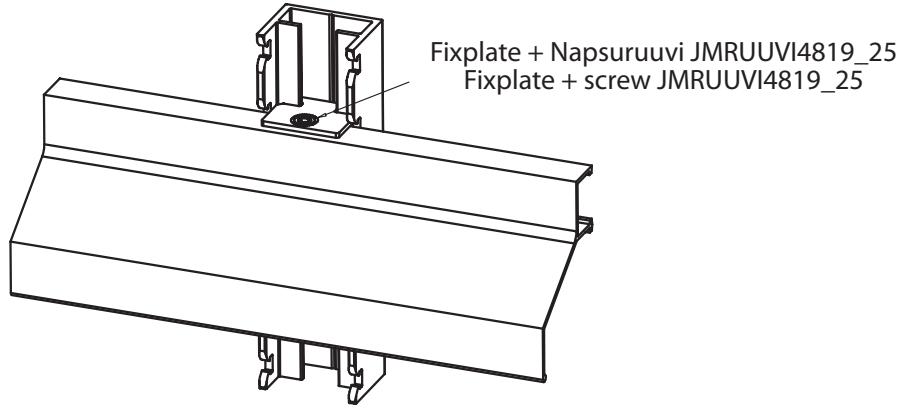

Ruuvikiinnitys, kts. sivut 1.7.1-1.7.7)
Installation with screws, see pages 1.7.1-1.7.7)

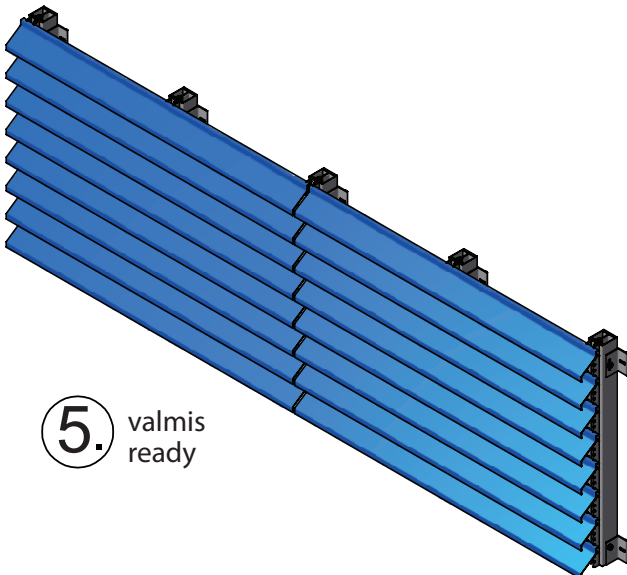
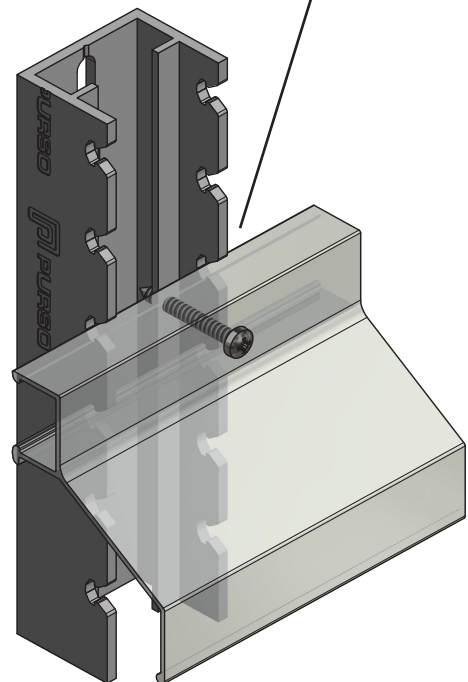

- 5.** valmis
ready

Säleen asennussuunta
Installation of lamell

Fixplate- tai ruuvikiinnitys pakollinen joka kiinnityskohdassa
Lamells will be fixed with Fixplate or screw at each attachment point

Fixplate kiinnitys suositeltava kiinnitystapa
Fixplate mounting recommended mounting method

Vaihtoehtoinen ruuvikiinnitys s.1.6.2
Alternative mounting with screws p.1.6.2

α = esim. ruuvi Ø4.2x32 A2
α = e.g. screw Ø4.2x32 A2

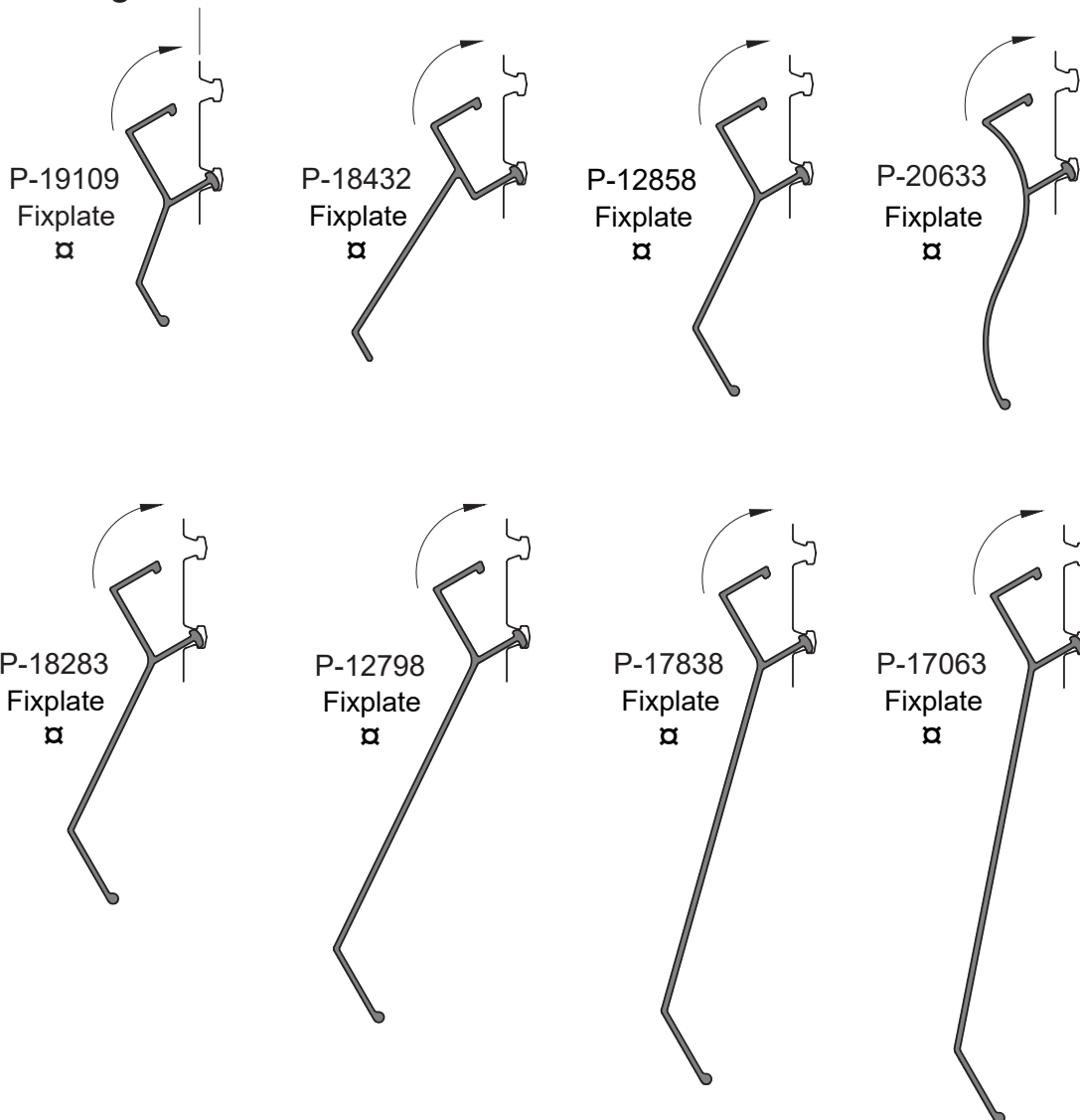

Säleen asennussuunta
Installation of lamell

Fixplate- tai ruuvikiinnitys pakollinen
Lamells will be fixed with Fixplate or screw

Fixplate kiinnitys suositeltava kiinnitystapa
Fixplate mounting recommended mounting method

Vaihtoehtoinen kiinnitystapa / Alternative mounting method

α = esim. ruuvi Ø4.2x32 A2 # = esim. ruuvi Ø4.2x38 A2

α = e.g. screw Ø4.2x32 A2 # = e.g. screw Ø4.2x38 A2

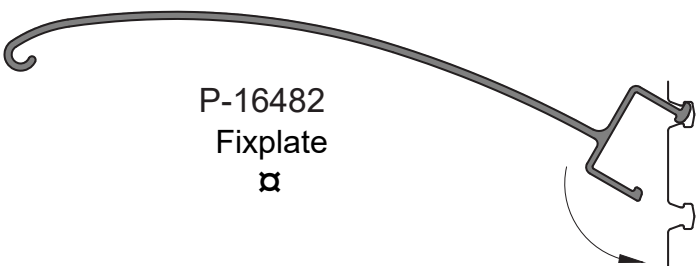
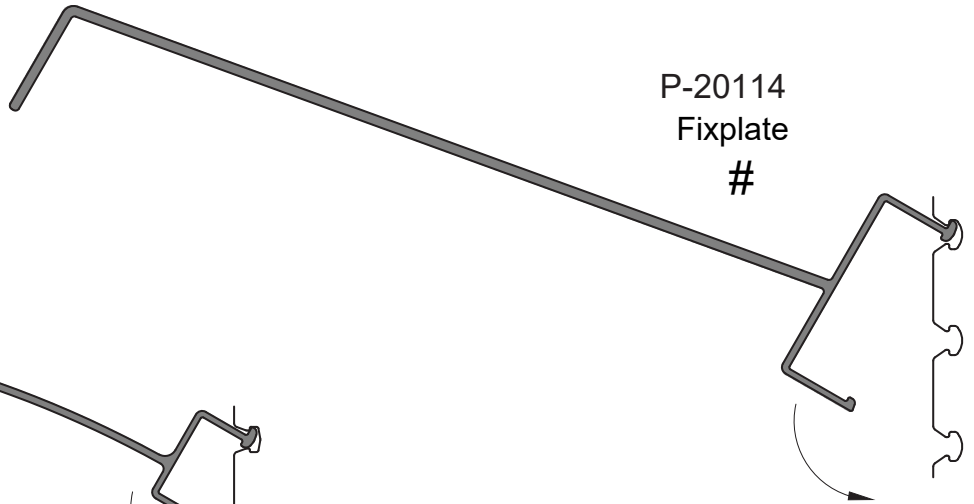
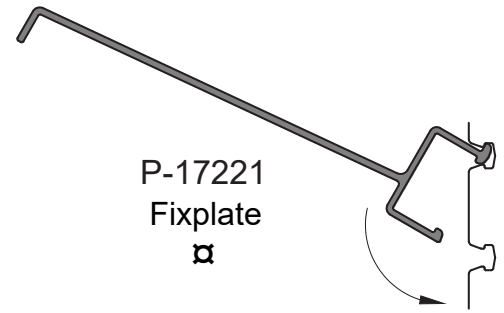
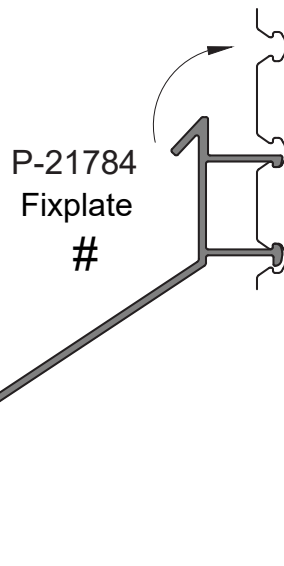
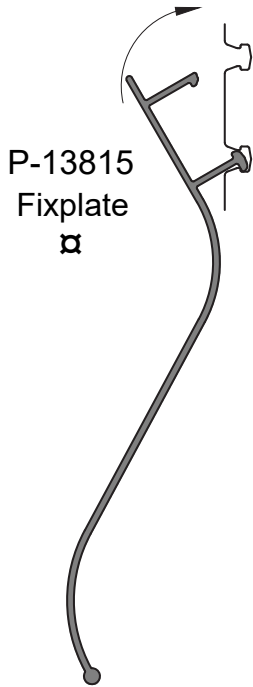

Säleen asennussuunta Installation of lamell

Fixplate kiinnitys pakollinen
Lamells will be fixed with Fixplate

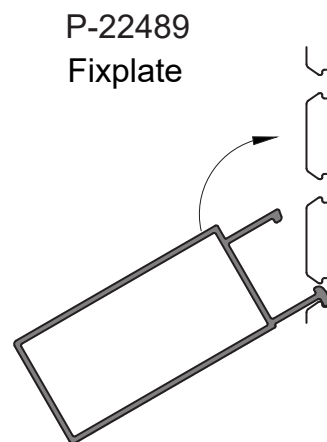
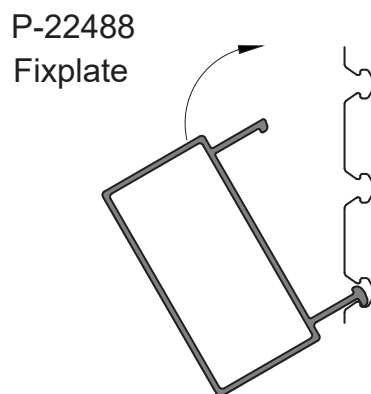
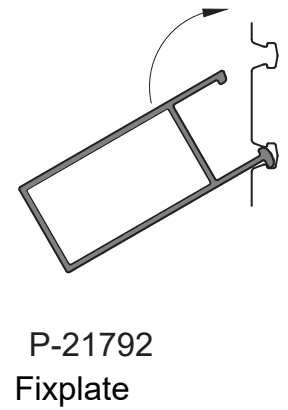
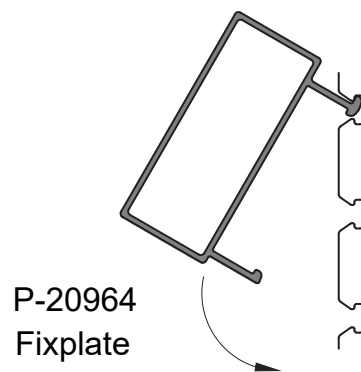
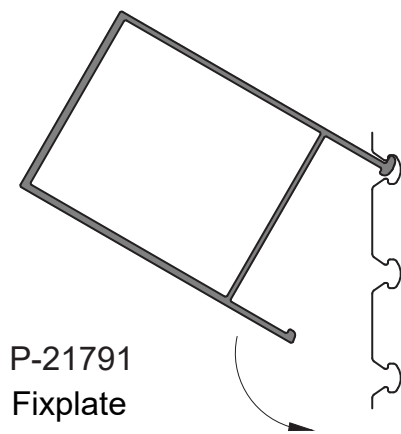

Säleen asennussuunta Installation of lamell

Fixplate- tai ruuvikiinnitys pakollinen

Lamells will be fixed with Fixplate or screw

Fixplate kiinnitys suositeltava kiinnitystapa

Fixplate mounting recommended mounting method

Vaihtoehtoinen kiinnitystapa / Alternative mounting method

α = esim. ruuvi 4.2x32 A2 # = esim. ruuvi 4.2x38 A2

α = e.g. screw 4.2x32 A2 # = e.g. screw 4.2x38 A2

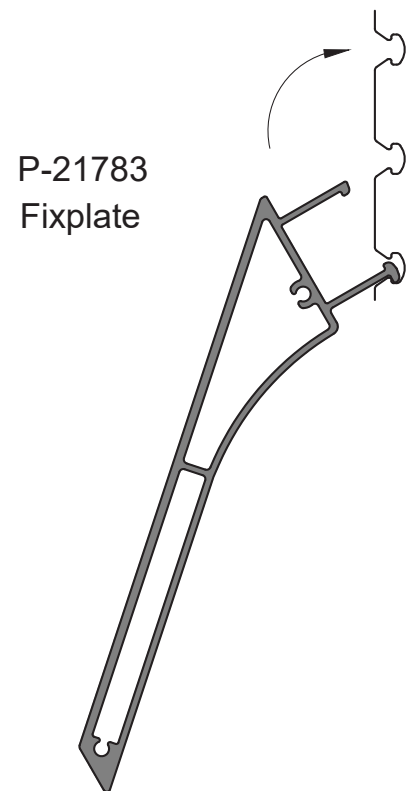
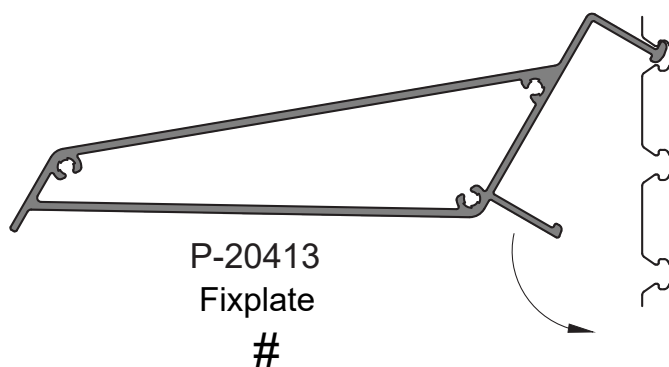
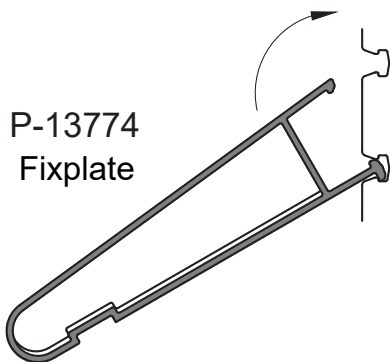
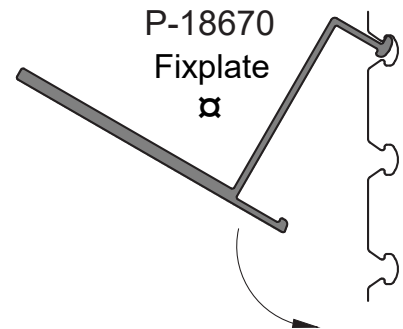
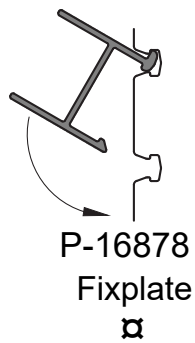
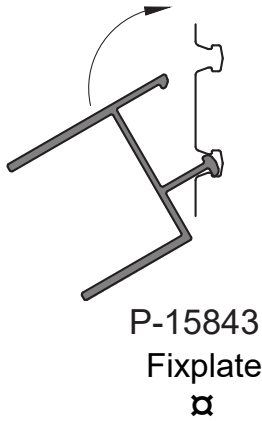

Säleen asennussuunta Installation of lamell

Fixplate kiinnitys pakollinen
Lamells will be fixed with Fixplate

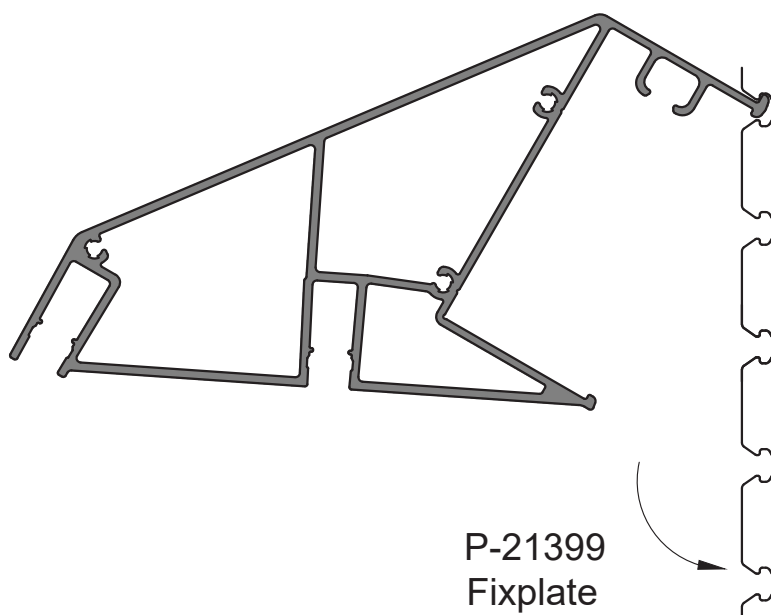
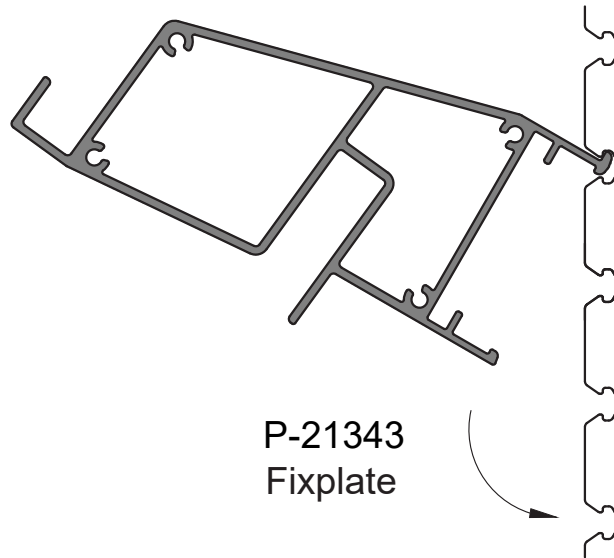

Säleen asennussuunta Installation of lamell

Fixplate kiinnitys pakollinen
Lamells will be fixed with Fixplate

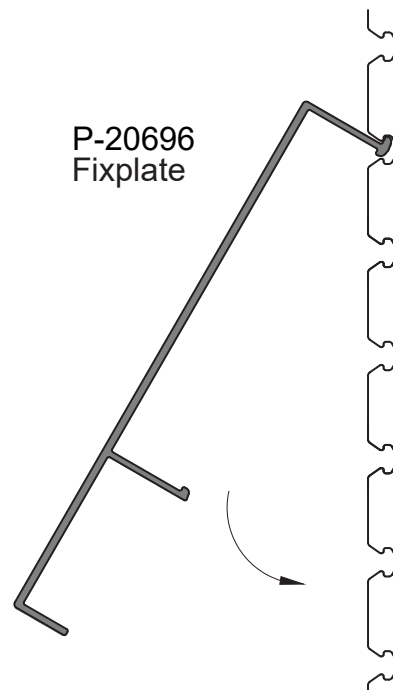
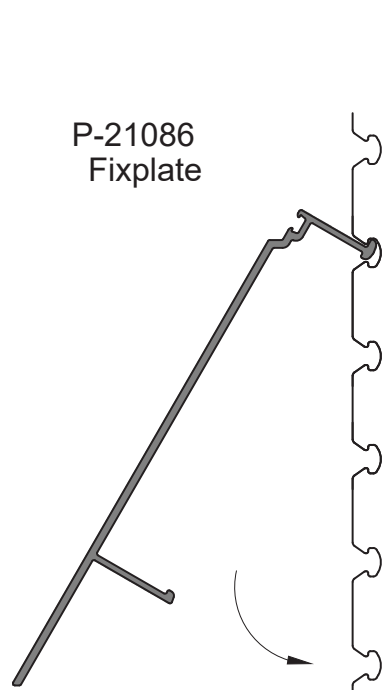
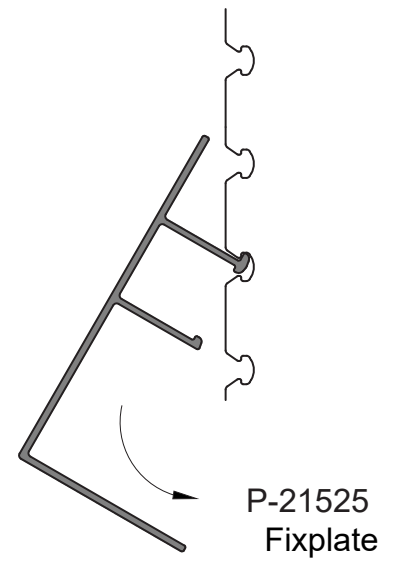
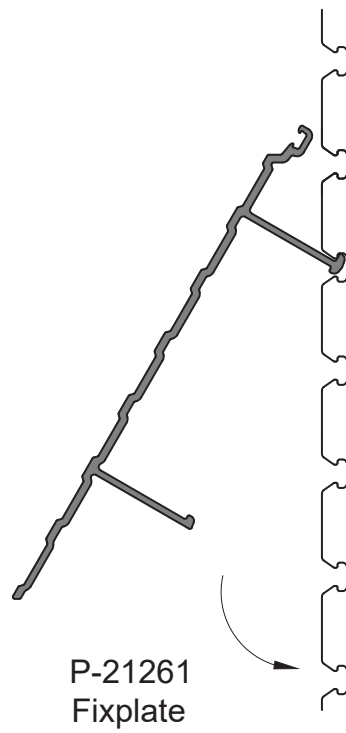
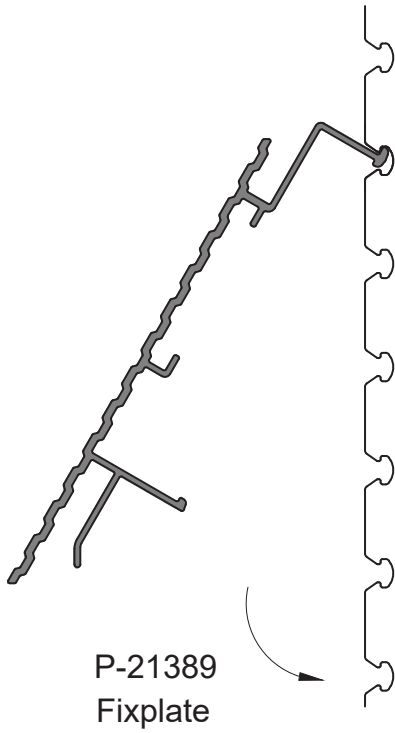

Säleen asennussuunta Installation of lamell

Fixplate kiinnitys pakollinen
Lamells will be fixed with Fixplate

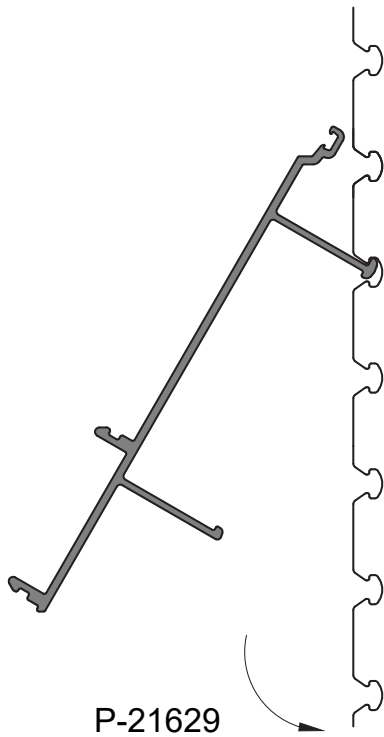

P-21629
Fixplate

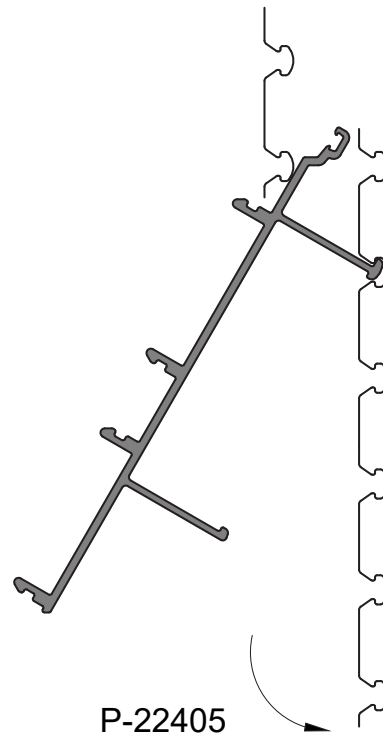

P-22405
Fixplate

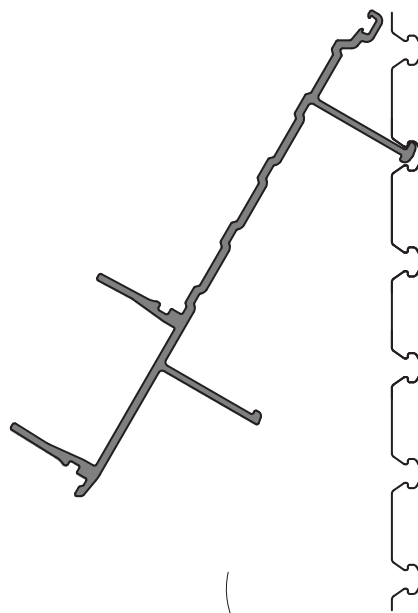

P-21400
Fixplate

NAPSU LISÄOSAT
ADDITIONAL PARTS

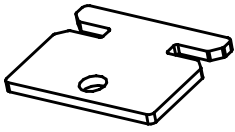

JMNapsuffixplate1
(materiaali ruostumaton teräs AISI304/A2)
(material stainless steel AISI 304/A2)



JMNapsuffixplate2
(materiaali ruostumaton teräs AISI304/A2)
(material stainless steel AISI 304/A2)

STEP 1

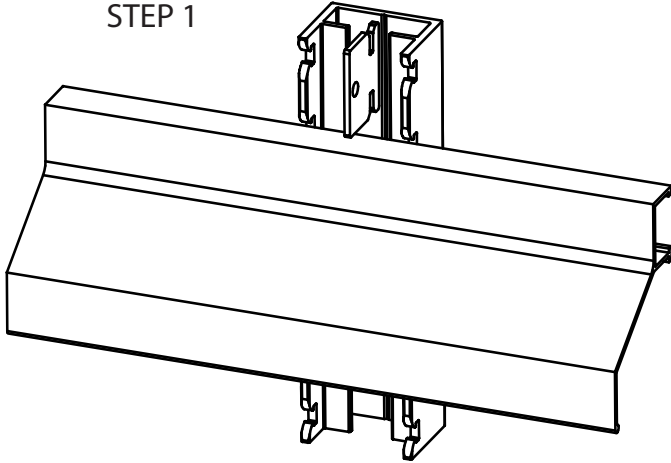

STEP 2

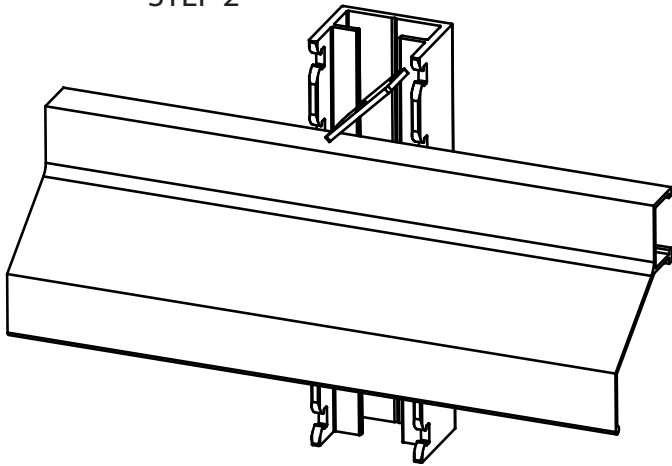

STEP 3

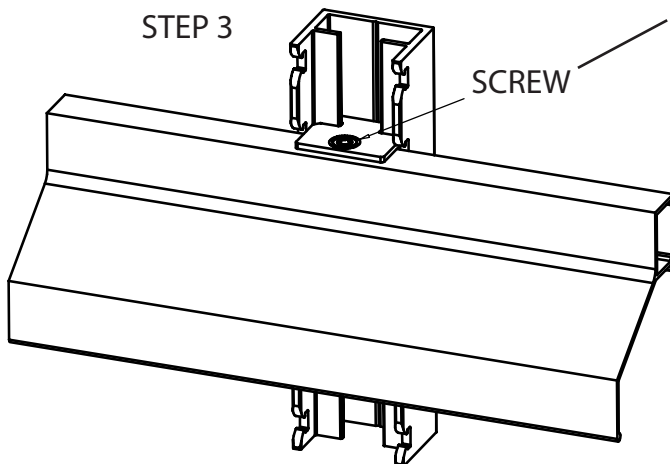

STEP 1

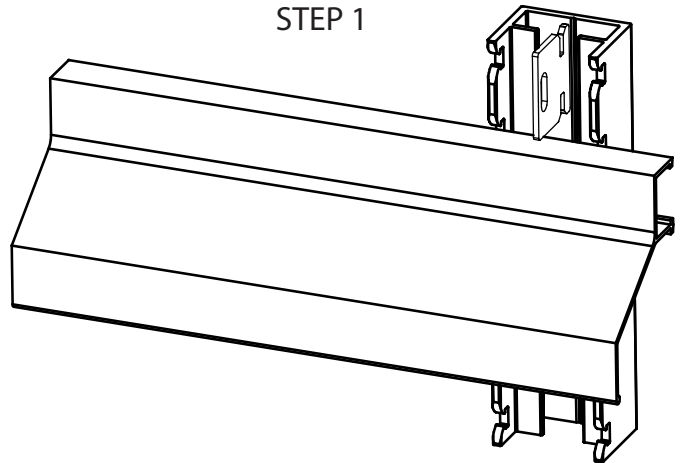

STEP 2

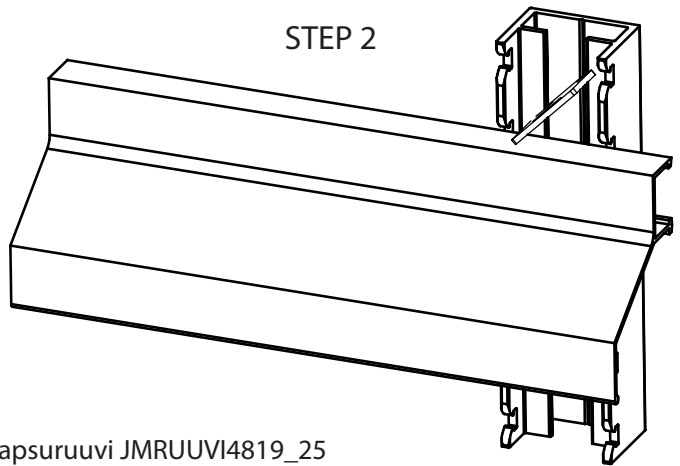

STEP 3

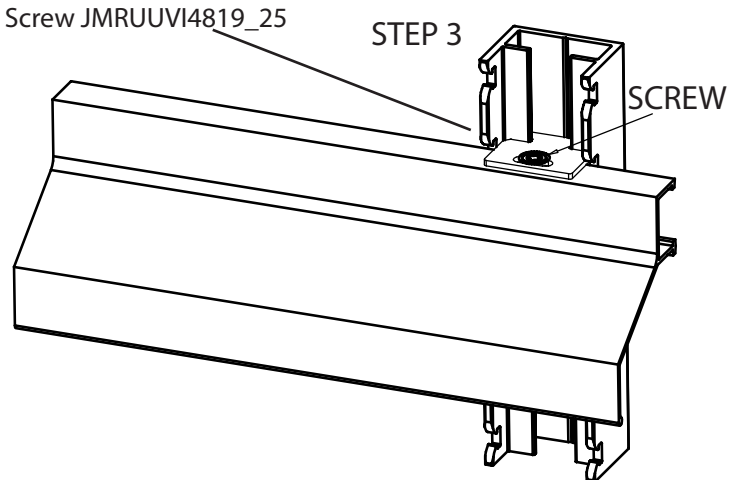

Napsuruuvi JMRUUVI4819_25

Screw JMRUUVI4819_25

**NAPSU LISÄOSAT
ADDITIONAL PARTS**

JMNapsuffixplate4
(materiaali ruostumaton teräs AISI304/A2)
(material stainless steel AISI 304/A2)

STEP 1

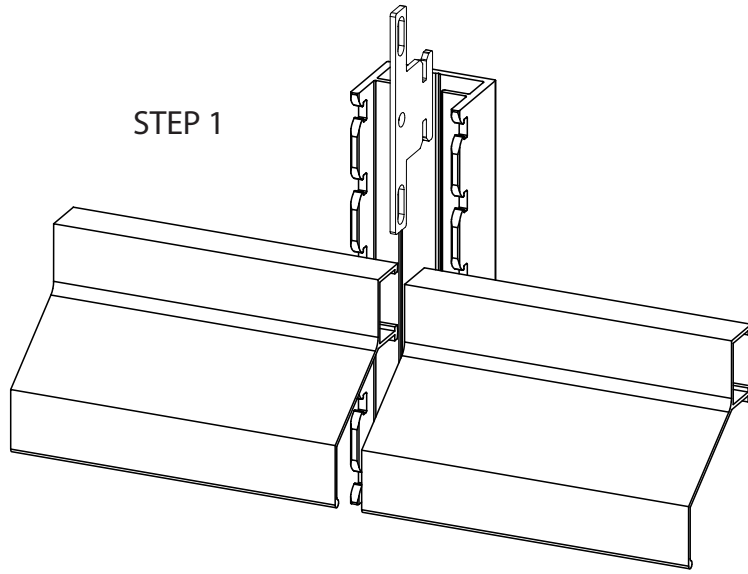
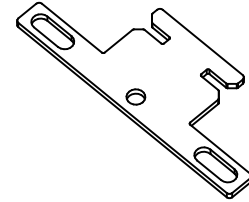

STEP 2

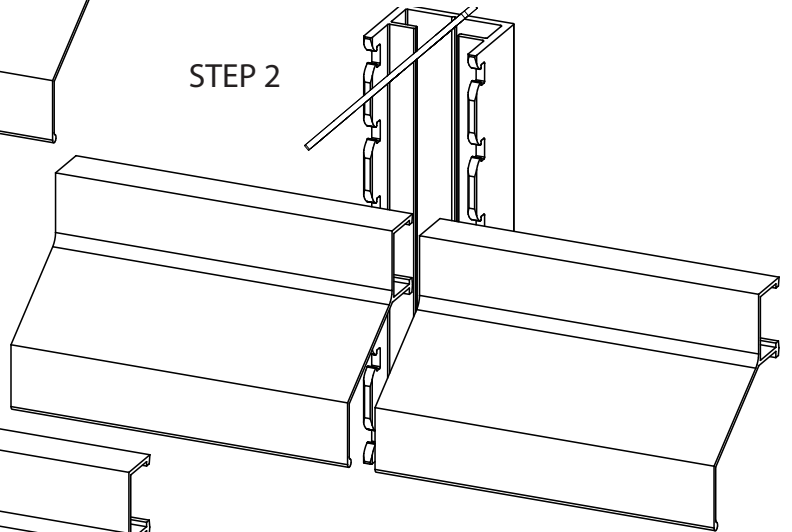

STEP 3

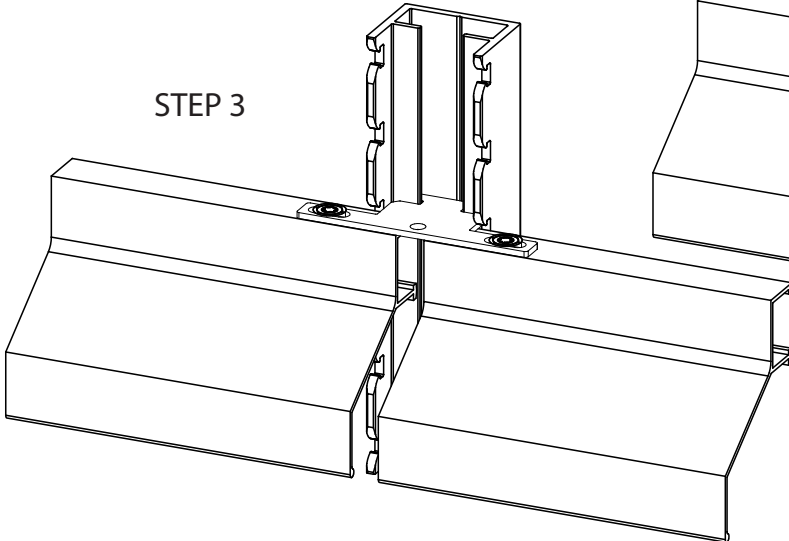

Napsuruuvit JMRUUVI4819_25
Screws JMRUUVI4819_25

JMNapsuffixplate4

JMNapsuffixplate1

JMNapsuffixplate4

SCREW

SCREW

SCREW

SCREW

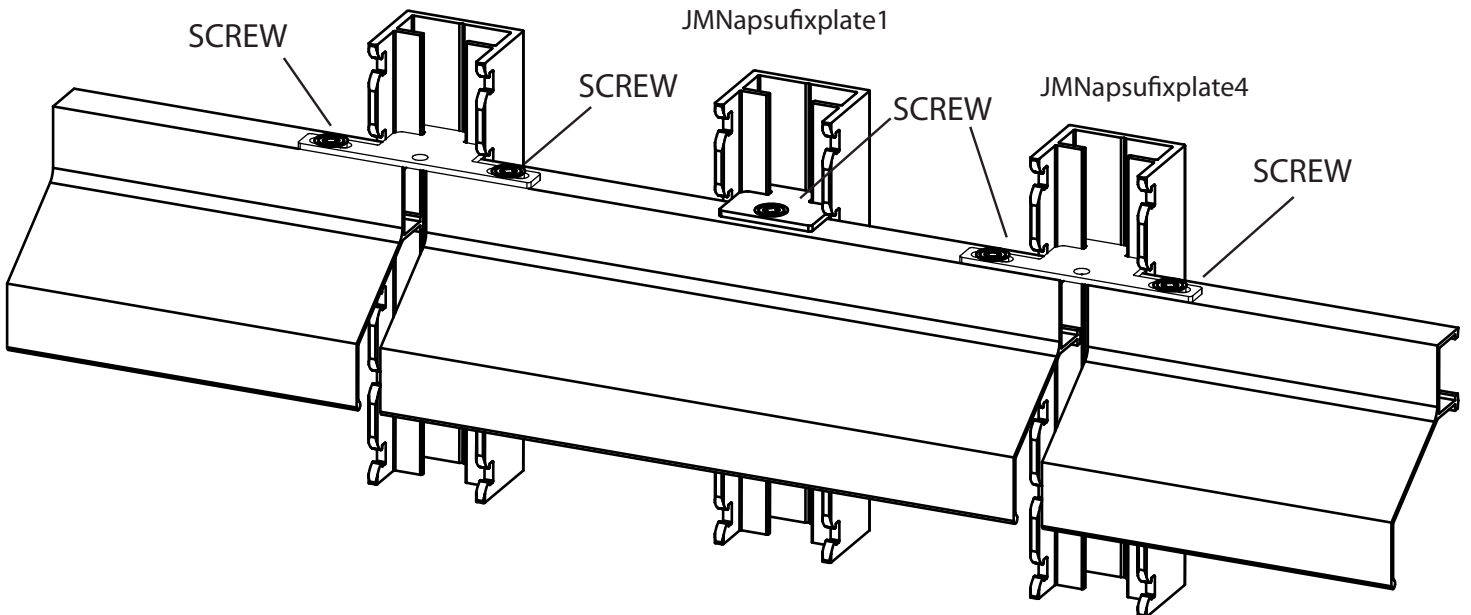

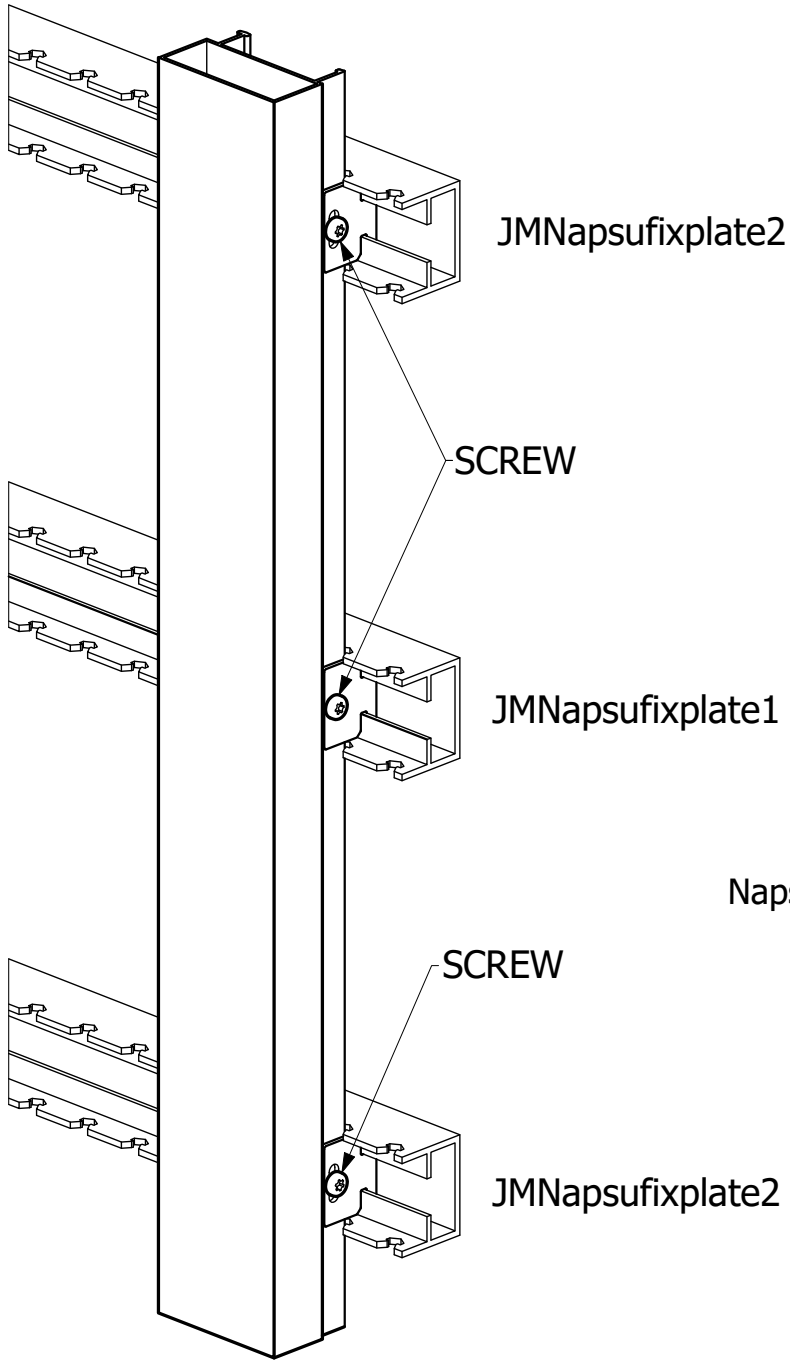

Napsuruuvi JMRUUVI4819_25
Screw JMRUUVI4819_25

NAPSU LISÄOSAT
ADDITIONAL PARTS

PEITEPROFIILIN P-22680 ASENNUS
INSTALLATION OF COVER PROFILE P-22680

STEP 1

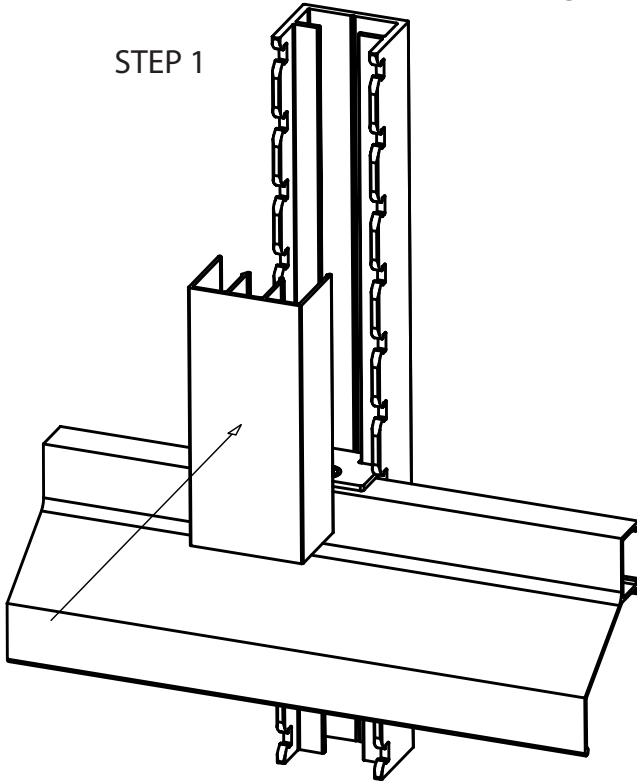

(P-22284) K2254

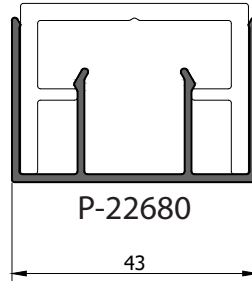

STEP 2

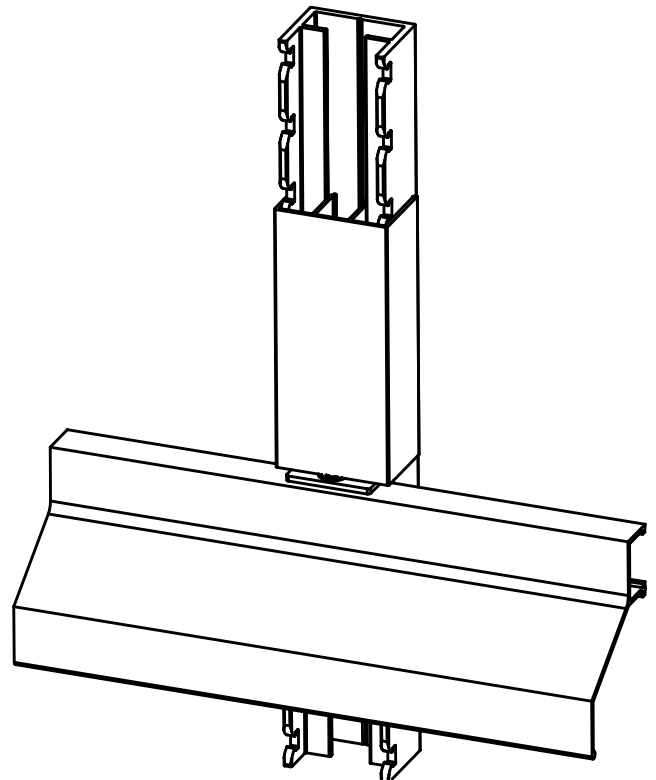

STEP 3

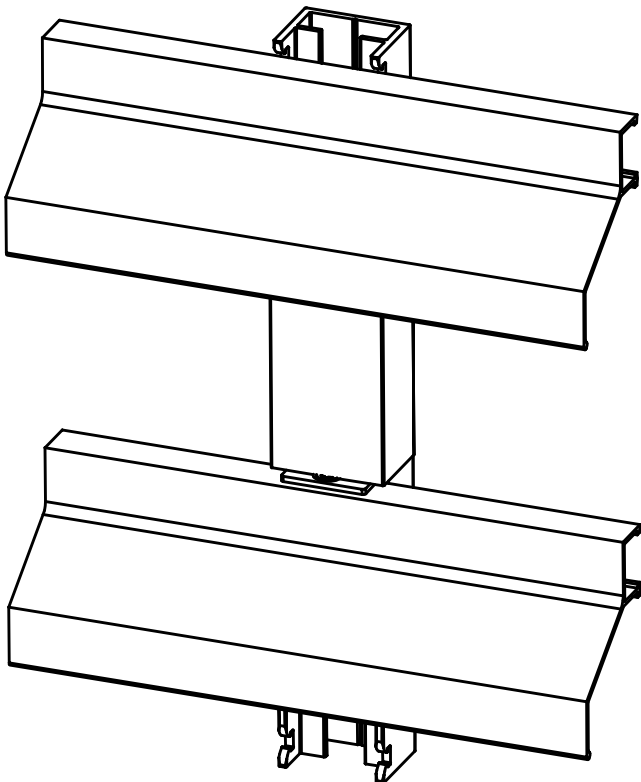

SUURIMMAT SUOSITELTAVAT JÄNNEVÄLIT NAPSU SÄLE PROFIILEILLE RECOMMENDED MAXIMUM SPAN OF NAPSU LAMELLA PROFILES

Säleet kuormitettuna heikoimpaan suuntaan. Kiinnitykset tarkastettava erikseen.

Lämpöliikkeet otettava huomioon kiinnityksissä.

Alumiinin lämpölaajenemiskerroin on $24 \cdot 10^{-6}/^{\circ}\text{C}$. Esim. lämpötilamuutoksen ollessa 70°C , säleen jonka pituus on 2000mm pituus muuttuu 3,4 mm

Lamellas are loaded at the weakest orientation. Mountin must be verified separately.

Thermal movement must be taken into account when mounting.

The thermal expansion coefficient of aluminium is $24 \cdot 10^{-6}/^{\circ}\text{C}$. A temperature chance of 70°C degrees, for instance, changes the length of a 2000 mm louvre by 3,4 mm.

		Kuormitus q Load q					
		Omapaino Dead weight		Omapaino + Tuuli 0.6 kN/m ² Dead weight+ Wind 0.6 kN/m ²		Omapaino + Tuuli 0.6 kN/m ² + Jää 0.45 kN/m ² Dead weight + Wind 0.6 kN/m ² + Ice 0.45 kN/m ²	
		$f_{sall} : L/500$		$f_{sall} : L/300$		$f_{sall} : L/100$	
		L_{max} (mm)		L_{max} (mm)		L_{max} (mm)	
Profile	kg/m	1-aukkoinen 1-span-beam.	2-aukkoinen 2-span-beam	1-aukkoinen 1-span-beam	2-aukkoinen 2-span-beam	1-aukkoinen 1-span-beam	2-aukkoinen 2-span-beam
P-12798	0.721	2000	2000	1200	1700	1500	1500
P-12858	0.478	2000	2000	1300	1700	1600	1600
P-21792	0.637	2000	2000	2000	2000	2000	2000
P-13774	0.964	2000	2000	1900	2000	2000	2000
P-13815	0.91	2000	2000	1500	2000	1800	1800
P-15843	0.602	2000	2000	2000	2000	2000	2000
P-16482	1.056	2000	2000	1500	2000	1800	1800
P-16878	0.308	2000	2000	1600	2000	2000	2000
P-17063	0.837	2000	2000	1100	1400	1300	1300
P-17221	0.745	2000	2000	1200	1700	1500	1700
P-17838	0.797	2000	2000	1100	1500	1400	1400

NAPSU säleiden maksimi käyttöpituus 4000 mm / maksimi toimituspituus 6600 mm.

* Maksimi säleen jänneväli 1-aukkoiset rakenteet (rakennemalli, jossa säle tuetaan/kiinnitetään päistään kahdesta pisteestä).
-> säleiden maksimi jänneväli taulukon mukaan.

* Maksimi säleen jänneväli 2-aukkoiset rakenteet (rakennemalli, jossa säle tuetaan/kiinnitetään päistään kahdesta pisteestä sekä kolmannelta pisteestä säleen keskeltä).
-> säleiden maksimijänneväli taulukosta (kun maksimi jänneväli 2000 mm, rajoitteena max. käyttöpituus $L=4000/2$.)

The maximum use of length for NAPSU lamella profiles is 4000 mm / The maximum delivery length is 6600 mm.

* 1-span-beams, louvre blades maximum span dimension from table

* 2-span-beams, louvre blades maximum span dimension from table (max. span 2000 mm caused by max profile use of length $L=4000/2$.)

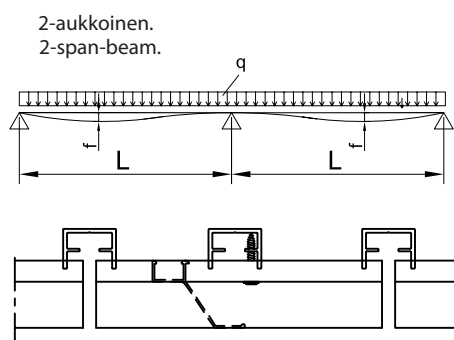
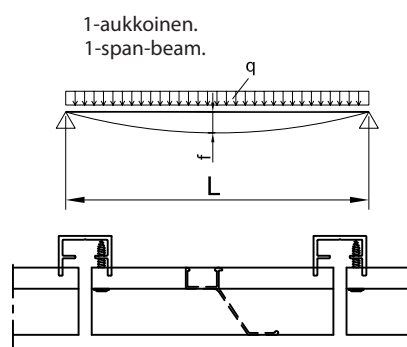

SUURIMMAT SUOSITELTAVAT JÄNNEVÄLIT NAPSU SÄLE PROFIILEILLE RECOMMENDED MAXIMUM SPAN OF NAPSU LAMELLA PROFILES

Säleet kuormitettuna heikoimpaan suuntaan. Kiinnitykset tarkastettava erikseen.

Lämpöliikkeet otettava huomioon kiinnityksissä.

Alumiinin lämpölaajenemiskerroin on $24 \cdot 10^{-6}/^{\circ}\text{C}$. Esim. lämpötilamuutoksen ollessa 70°C , säleen jonka pituus on 2000mm pituus muuttuu 3,4 mm

Lamellas are loaded at the weakest orientation. Mountin must be verified separately.

Thermal movement must be taken into account when mounting.

The thermal expansion coefficient of aluminium is $24 \cdot 10^{-6}/^{\circ}\text{C}$. A temperature change of 70°C degrees, for instance, changes the length of a 2000 mm louvre by 3,4 mm.

	kg/m	Kuormitus q Load q					
		Omapaino Dead weight		Omapaino + Tuuli 0.6 kN/m ² Dead weight+ Wind 0.6 kN/m ²		Omapaino + Tuuli 0.6 kN/m ² + Jää 0.45 kN/m ² Dead weight + Wind 0.6 kN/m ² + Ice 0.45 kN/m ²	
		$f_{sall} : L/500$		$f_{sall} : L/300$		$f_{sall} : L/100$	
		L_{max} (mm)		L_{max} (mm)		L_{max} (mm)	
Profile		1-aukkoinen 1-span-beam.	2-aukkoinen 2-span-beam	1-aukkoinen 1-span-beam	2-aukkoinen 2-span-beam	1-aukkoinen 1-span-beam	2-aukkoinen 2-span-beam
P-18283	0.567	2000	2000	1300	1700	1600	1600
P-18432	0.505	2000	2000	1300	1600	1500	1500
P-18670	0.845	2000	2000	2000	2000	2000	2000
P-19109	0.383	2000	2000	1900	2000	2000	2000
P-20114	1.985	2000	2000	2000	2000	2000	2000
P-20413	1.852	2000	2000	2000	2000	2000	2000
P-20633	0.462	2000	2000	1300	1700	1600	1600
P-20696	1.085	2000	2000	1400	1900	1600	1600
P-20964	0.767	2000	2000	2000	2000	2000	2000
P-21086	0.983	2000	2000	1400	1900	1600	1600
P-22678	1.504	2000	2000	2000	2000	2000	2000

NAPSU säleiden maksimi käyttöpituus 4000 mm / maksimi toimituspituus 6600 mm.

* Maksimi säleen jänneväli 1-aukkoiset rakenteet (rakennemalli, jossa säle tuetaan/kiinnitetään päistään kahdesta pisteestä).
-> säleiden maksimi jänneväli taulukon mukaan.

* Maksimi säleen jänneväli 2-aukkoiset rakenteet (rakennemalli, jossa säle tuetaan/kiinnitetään päistään kahdesta pisteestä sekä kolmannelta pisteestä säleen keskeltä).

-> säleiden maksimijänneväli taulukosta (kun maksimi jänneväli 2000 mm, rajoitteena max. käyttöpituus $L=4000/2$.)

The maximum use of length for NAPSU lamella profiles is 4000 mm / The maximum delivery length is 6600 mm.

* 1-span-beams, louvre blades maximum span dimension from table

* 2-span-beams, louvre blades maximum span dimension from table (max. span 2000 mm caused by max profile use of length $L=4000/2$.)

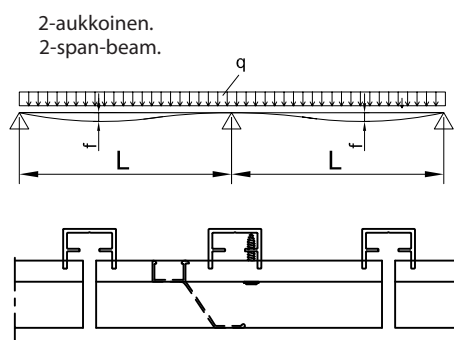
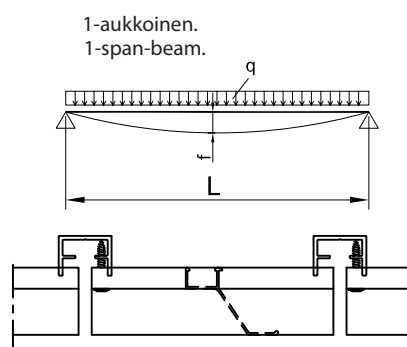

P50L PEITTEIDEN LIITTÄMINEN NAPSU JÄRJESTELMÄÄN
 MOUNTING P50L COVER PROFILES TO NAPSU SYSTEM

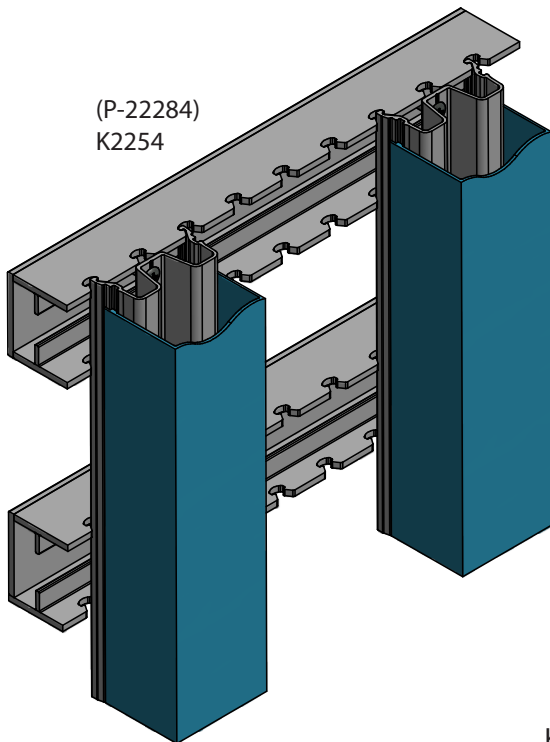

P50L sarjan peitteiden kanssa
 käytetään väliprofilia P-18541
 Mounting profile P-18541 needs to be used
 with P50L cover profiles

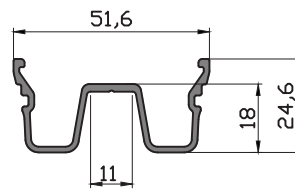

P-18541

Kiinnitysprofilia P-18541 voidaan käyttää pysty- ja vaakatasossa
 Mounting profile P-18541 can be used vertically and horizontal

Esimerkkejä P50L sarjan peitteistä
 Lisää peitevaihtoehtoja P50L sarjan esitteessä
 (tarkista peitteen yhteensopivuus väliprofilin kanssa)

Examples of P50L cover profiles
 More cover profiles can be found from
 the P50L catalogue
 (check compatibility between
 covers and mounting profile)

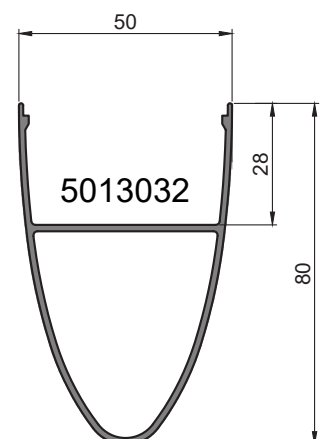
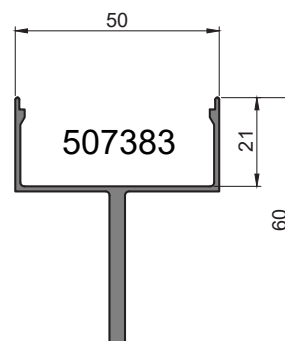
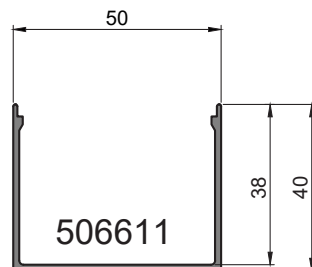
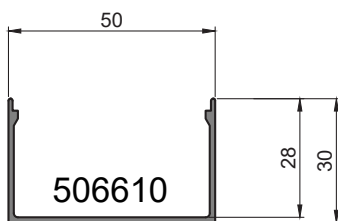

**P50L PEITTEIDEN LIITTÄMINEN NAPSU JÄRJESTELMÄÄN
MOUNTING P50L COVER PROFILES TO NAPSU SYSTEM**

Kiinnitysprofili P-18541 voidaan käyttää pysty- ja vaakatasossa
Mounting profile P-18541 can be used vertically and horizontal

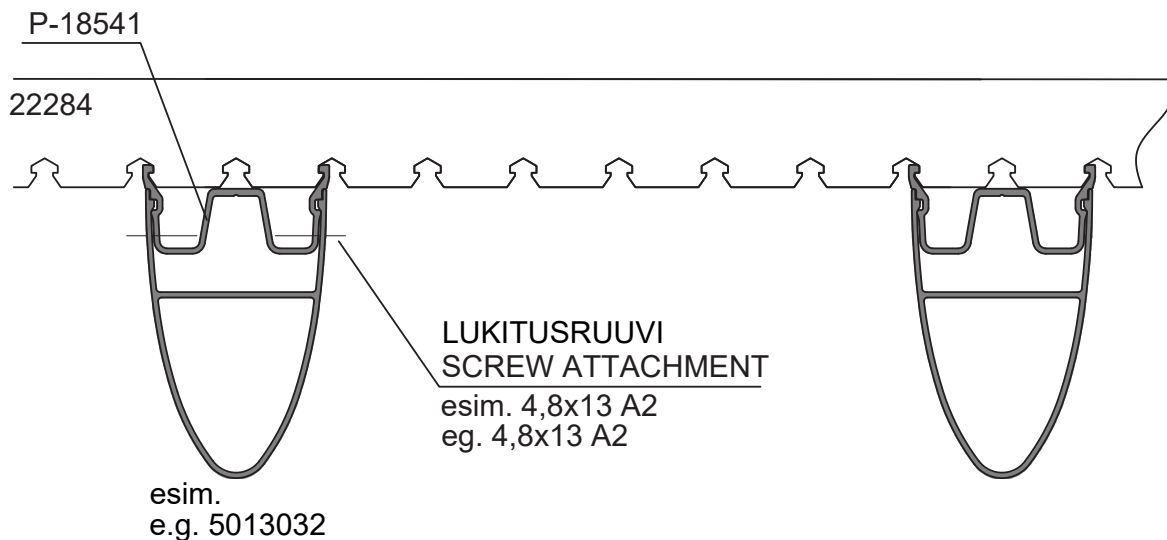
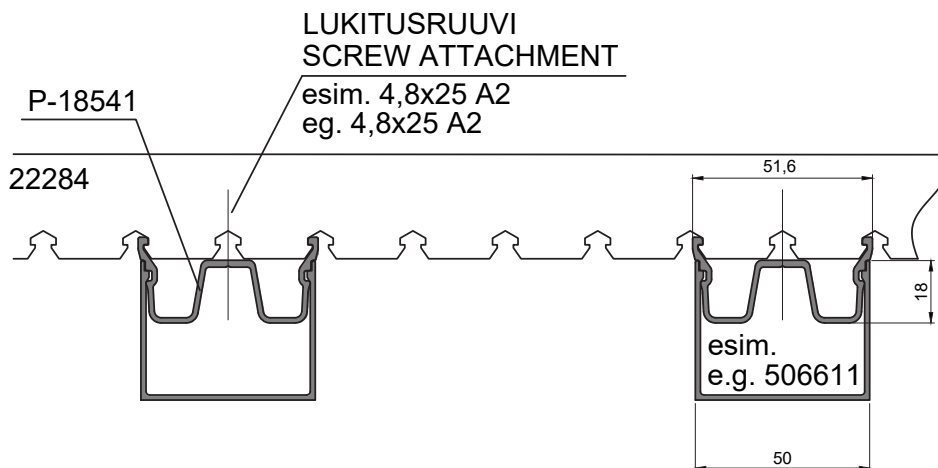
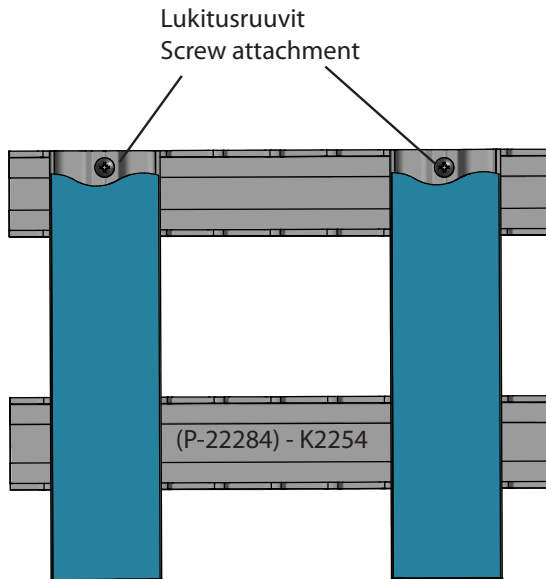

Peiteprofiilin yhteenspiuvuus
väliprofiiliin P-18541 varmistettava

Compatibility of cover profiles needs to be
ensured with mounting profile P-18541

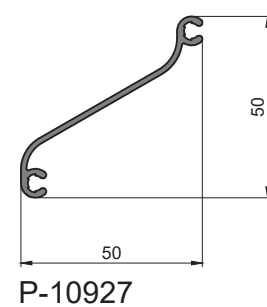
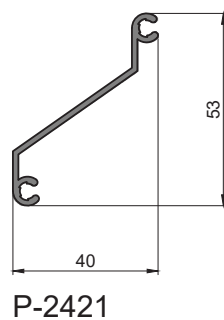
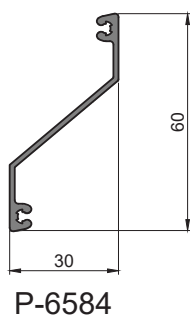
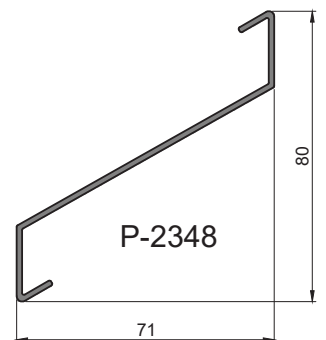
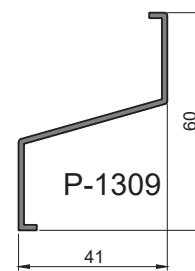
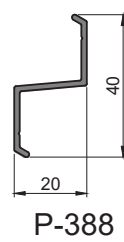
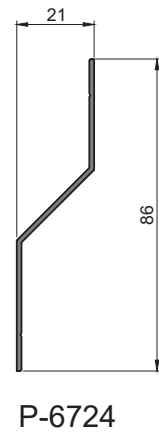
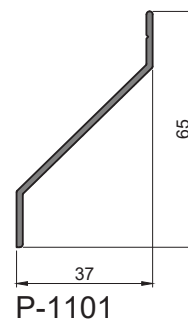
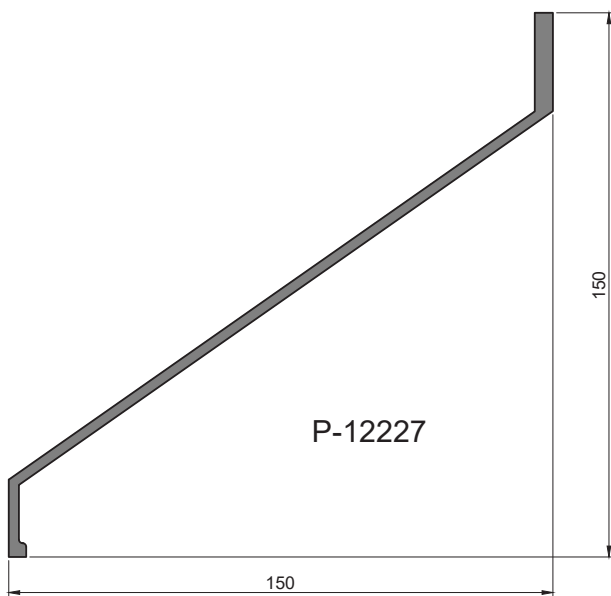
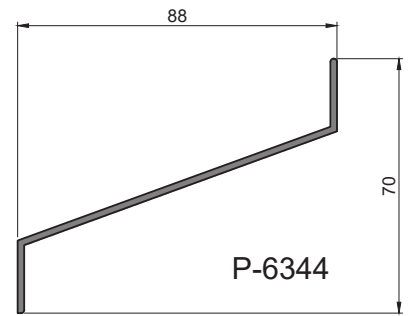
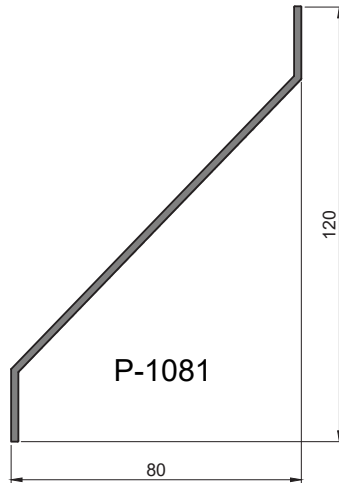
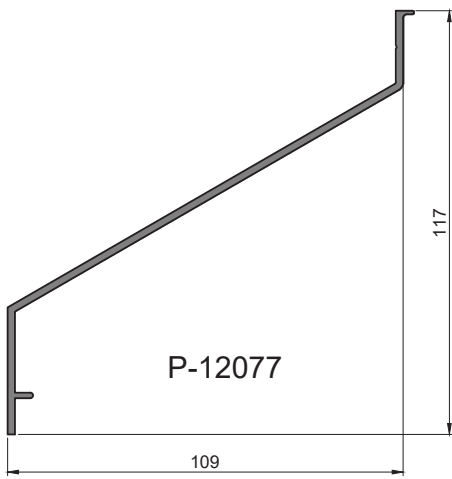

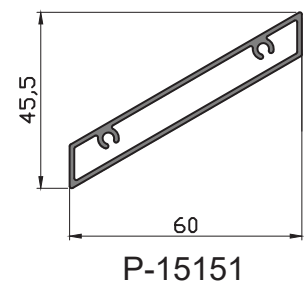
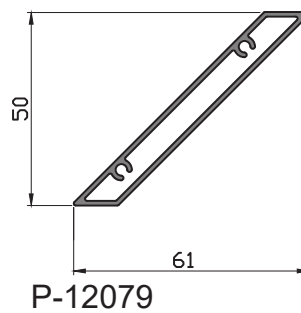
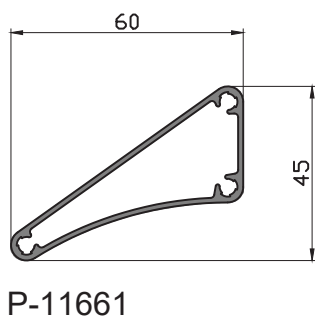
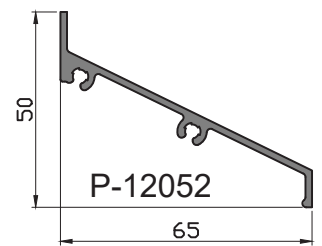
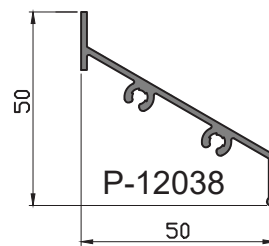
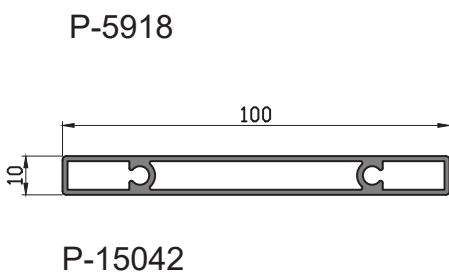
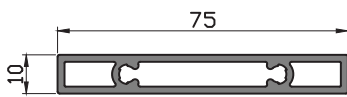
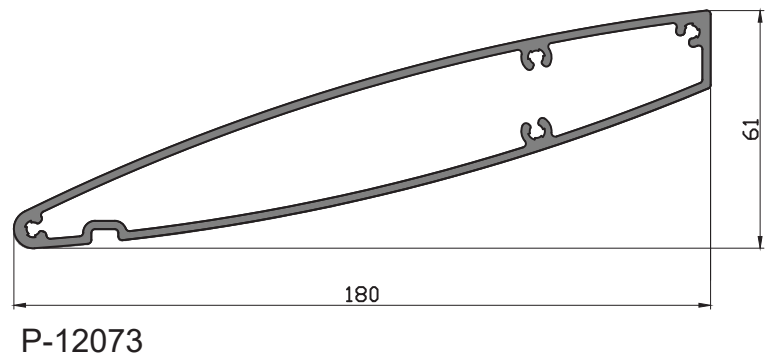
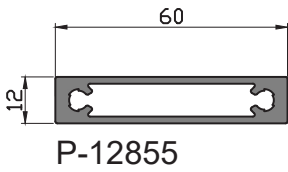
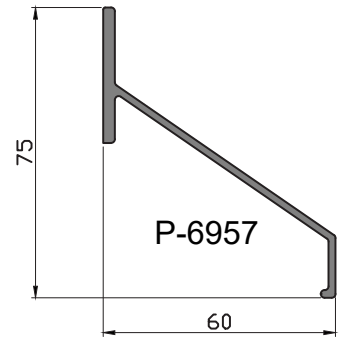
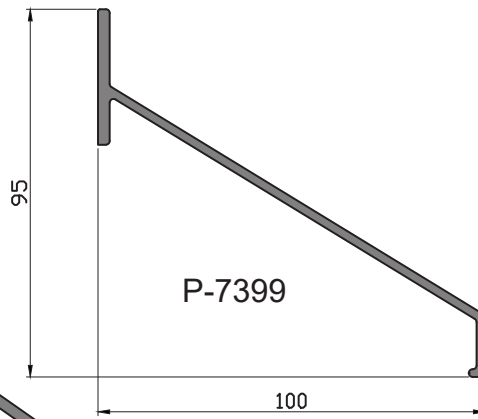
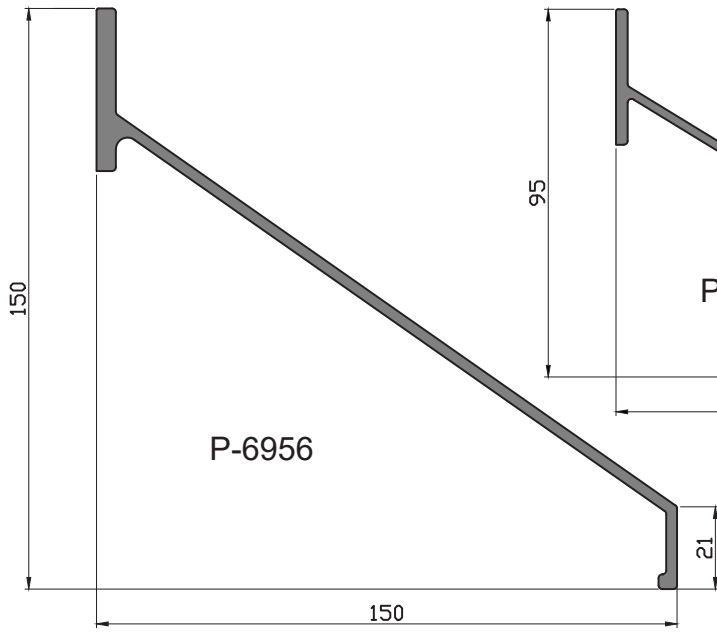

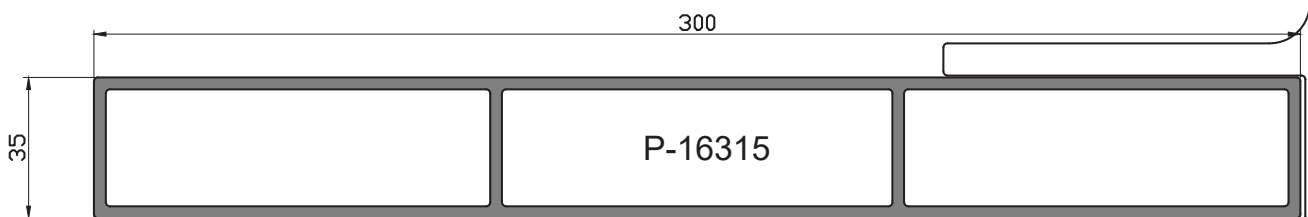
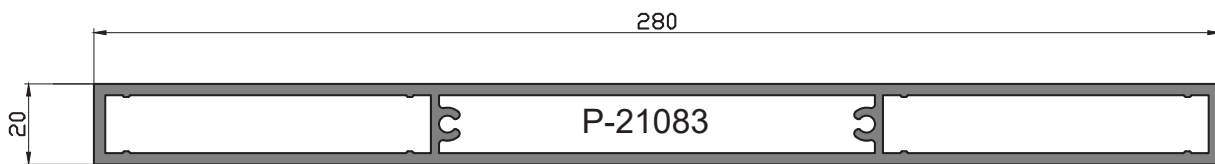
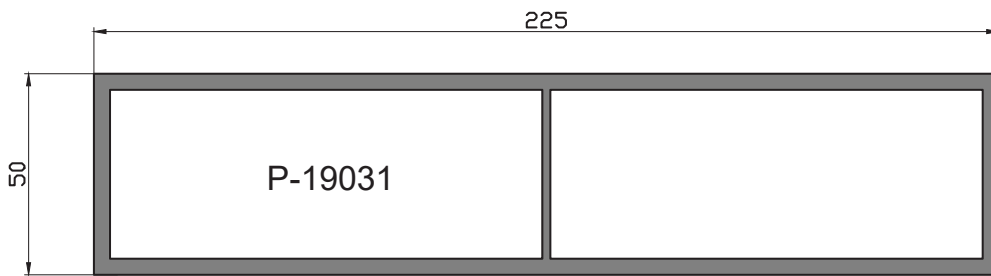
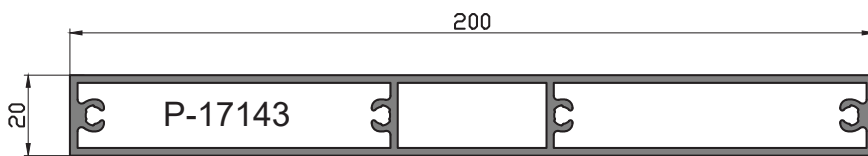
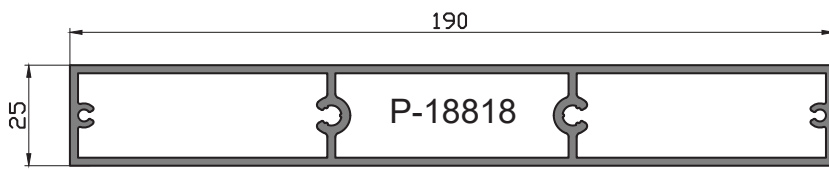
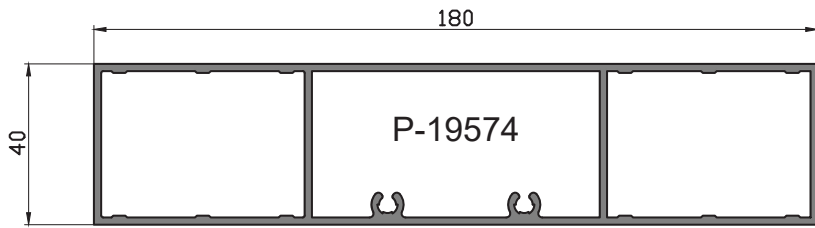
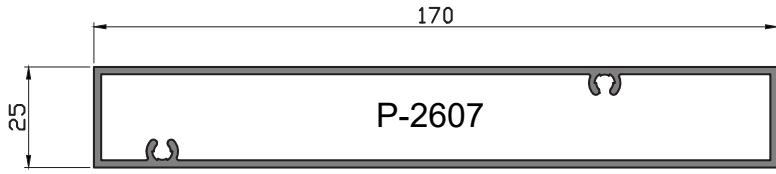

19915

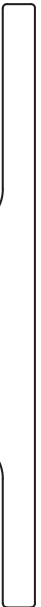

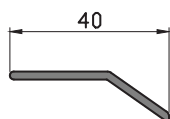

P-18289

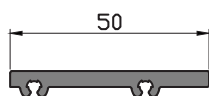

P-4686

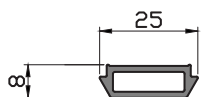

P-5025

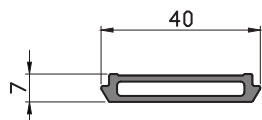

P-8249

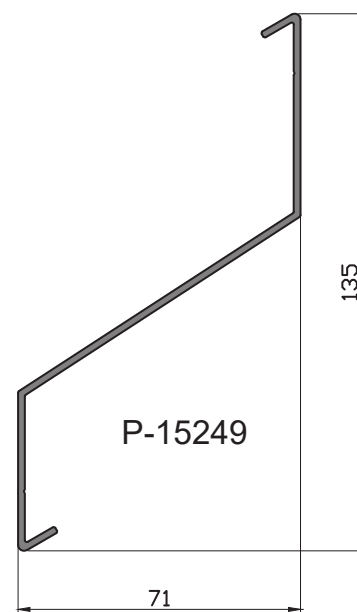

P-15249

**SIIPISÄLEET
WING**

15966/K

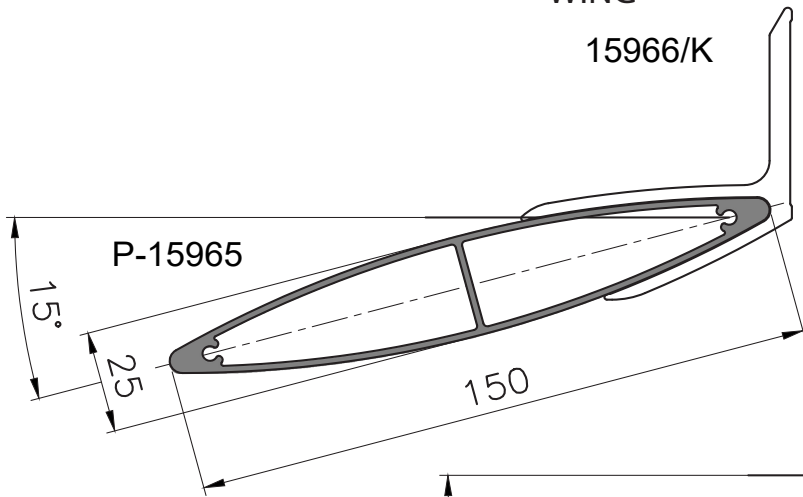

18708/K

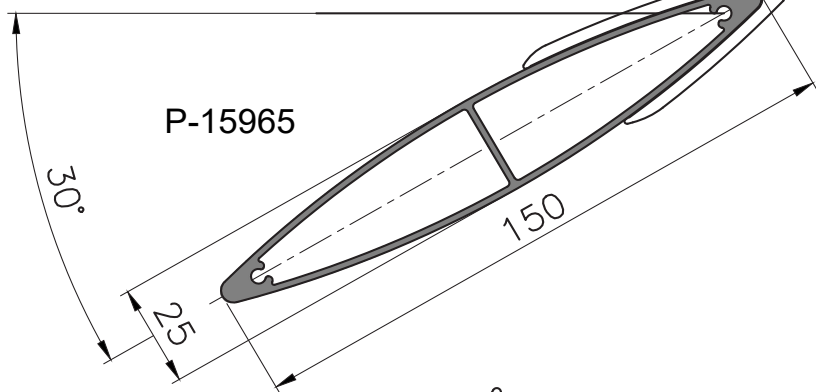

22070/K

P-22071

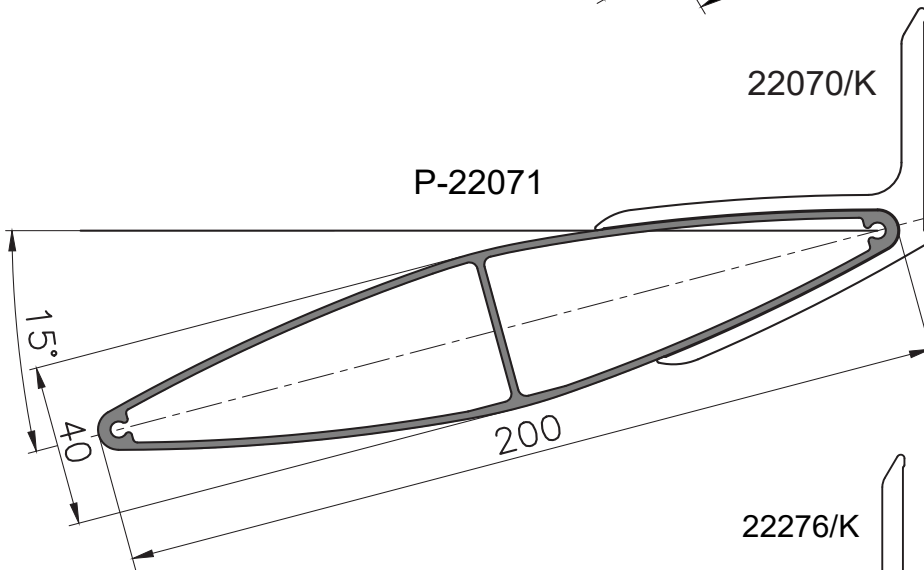

22276/K

P-22071

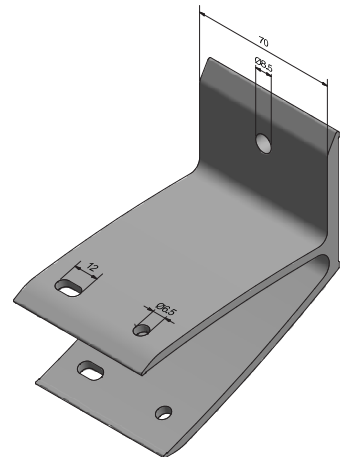
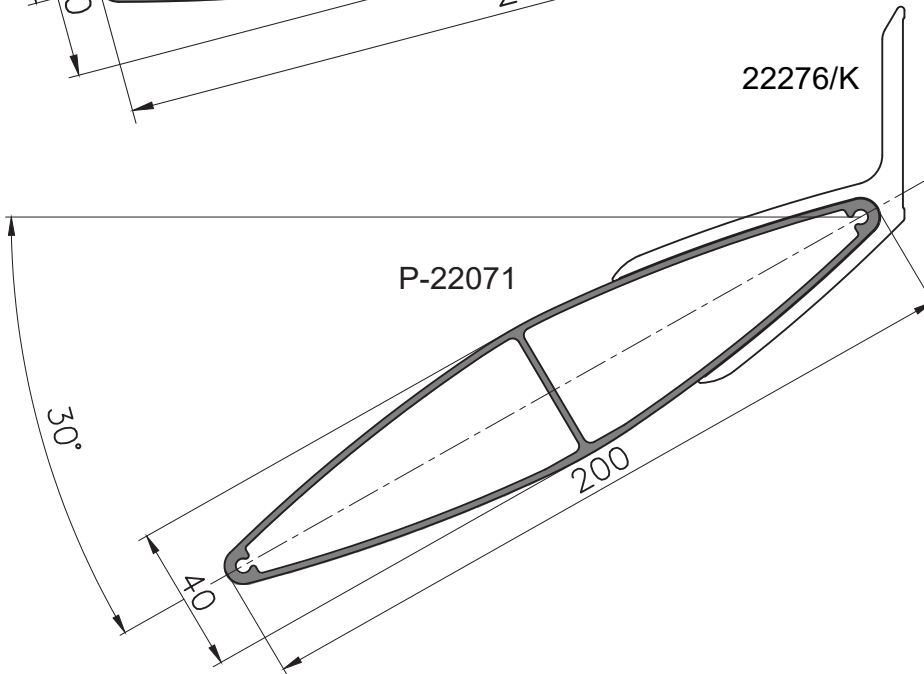

Kiinnityskorvake
Mounting brackets
15°



Kiinnityskorvake
Mounting brackets
30°

SUURIMMAT SUOSITELTAVAT JÄNNEVÄLIT SÄLEPROFIILEILLE RECOMMENDED MAXIMUM SPAN OF LAMELLA PROFILES

Säleet kuormitettuna heikoimpaan suuntaan. Kiinnitykset tarkastettava erikseen.

Lämpöliikkeet otettava huomioon kiinnityksissä.

Alumiinin lämpölaajenemiskerroin on $24 \cdot 10^{-6}/^{\circ}\text{C}$. Esim. lämpötilamuutoksen ollessa 70°C , säleen jonka pituus on 2000mm pituus muuttuu 3,4 mm

Lamellas are loaded at the weakest orientation. Mountin must be verified separately.

Thermal movement must be taken into account when mounting.

The thermal expansion coefficient of aluminium is $24 \cdot 10^{-6}/^{\circ}\text{C}$. A temperature change of 70°C degrees, for instance, changes the length of a 2000 mm louvre by 3,4 mm.

Profile	kg/m	Kuormitus q Load q					
		Omapaino Dead weight		Omapaino + Tuuli 0.6 kN/m ² Dead weight + Wind 0.6 kN/m ²		Omapaino + Tuuli 0.6 kN/m ² + Jää 0.45 kN/m ² Dead weight + Wind 0.6 kN/m ² + Ice 0.45 kN/m ²	
		$f_{sall}: L/500$		$f_{sall}: L/300$		$f_{sall}: L/100$	
		L_{max} (mm)		L_{max} (mm)		L_{max} (mm)	
		1-aukkoinen 1-span-beam	2-aukkoinen 2-span-beam	1-aukkoinen 1-span-beam	2-aukkoinen 2-span-beam	1-aukkoinen 1-span-beam	2-aukkoinen 2-span-beam
P-388	0.240	1800	2400	900	1200	1100	1500
P-1081	0.818	1500	2000	800	1000	900	1000
P-1101	0.365	1300	1700	600	800	700	900
P-1309	0.394	2400	3200	1200	1600	1500	1800
P-2348	0.562	2200	3000	1100	1500	1300	1700
P-2421	0.383	1500	2000	800	1000	900	1100
P-6344	0.635	1900	2500	1000	1300	1200	1200
P-6584	0.389	1600	2200	800	1100	1000	1400
P-6724	0.329	1600	2200	700	1000	900	1100
P-6956	2.087	2300	3200	1400	1900	1700	1800
P-6957	0.699	2200	3000	1200	1700	1500	1600
P-7399	1.053	2100	2800	1200	1600	1400	1500
P-10927	0.394	1400	2000	700	1000	900	1000
P-12038	0.470	1400	1800	700	1000	900	1100
P-12052	0.581	1400	1800	700	1000	900	1000
P-12077	0.991	2400	3200	1300	1700	1500	1500
P-12227	1.890	2100	2800	1200	1600	1500	1500
P-15249	0.875	3100	3300	1600	2200	2000	2200

Säleprofiilien maksimi toimitus/käyttöpituus 6600 mm.

* Maksimi säleen jänneväli 1-aukkoiset rakenteet (rakennemalli, jossa säle tuetaan/kiinnitetään päistään kahdesta pisteestä).

-> säleiden maksimi jänneväli taulukon mukaan.

* Maksimi säleen jänneväli 2-aukkoiset rakenteet (rakennemalli, jossa säle tuetaan/kiinnitetään päistään kahdesta pisteestä sekä kolmannelta pisteestä säleen keskeltä).

-> säleiden maksimijänneväli taulukosta (kun maksimi jänneväli 3300 mm, rajoitteena max. profiilimitta L/2.)

The maximum use of length/ delivery length for lamella profiles 6600 mm.

* 1-span-beams, louvre blades maximum span dimension from table

* 2-span-beams, louvre blades maximum span dimension from table (max. span 3300 mm caused by max profile length L/2.)

1-aukkoinen päistä tuettu rakenne.
1-span beam.

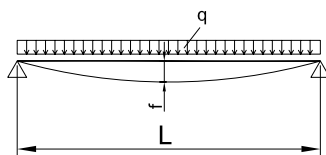

2-aukkoinen päistä ja keskeltä tuettu rakenne.
2-span beam.

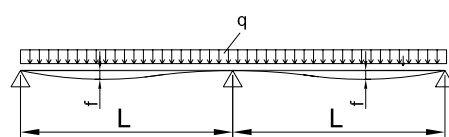

SUURIMMAT SUOSITELTAVAT JÄNNEVÄLIT SÄLEPROFIILEILLE RECOMMENDED MAXIMUM SPAN OF LAMELLA PROFILES

Säleet kuormitettuna heikoimpaan suuntaan. Kiinnitykset tarkastettava erikseen.

Lämpöliikkeet otettava huomioon kiinnityksissä.

Alumiinin lämpölaajenemiskerroin on $24 \cdot 10^{-6}/^{\circ}\text{C}$. Esim. lämpötilamuutoksen ollessa 70°C , säleen jonka pituus on 2000mm pituus muuttuu 3,4 mm

Lamellas are loaded at the weakest orientation. Mountin must be verified separately.

Thermal movement must be taken into account when mounting.

The thermal expansion coefficient of aluminium is $24 \cdot 10^{-6}/^{\circ}\text{C}$. A temperature change of 70°C degrees, for instance, changes the length of a 2000 mm louvre by 3,4 mm.

Profile	kg/m	Kuormitus q Load q					
		Omapaino Dead weight		Omapaino + Tuuli 0.6 kN/m ² Dead weight + Wind 0.6 kN/m ²		Omapaino + Tuuli 0.6 kN/m ² + Jää 0.45 kN/m ² Dead weight + Wind 0.6 kN/m ² + Ice 0.45 kN/m ²	
		$f_{sall}: L/500$		$f_{sall}: L/300$		$f_{sall}: L/100$	
		L_{max} (mm)		L_{max} (mm)		L_{max} (mm)	
		1-aukkoinen 1-span-beam	2-aukkoinen 2-span-beam	1-aukkoinen 1-span-beam	2-aukkoinen 2-span-beam	1-aukkoinen 1-span-beam	2-aukkoinen 2-span-beam
P-2607	1.960	3600	3300	2300	3100	2800	3300
P-4686	0.567	2000	2700	1200	1200	1000	1000
P-5025	0.230	1400	2000	800	1200	1000	1400
P-5918	0.913	1800	2400	1100	1500	1400	1900
P-8249	0.362	1300	1700	800	1000	900	1300
P-11661	0.653	2800	3300	1700	2300	2100	2600
P-12073	2.503	3600	3300	2400	3200	2900	3300
P-12079	0.564	1600	2200	900	1200	1100	1500
P-12855	0.853	2000	2700	1300	1800	1600	2200
P-15042	0.891	1800	2500	1100	1500	1300	1800
P-15151	0.575	1800	2400	1000	1400	1200	1700
P-15526	4.228	4800	3300	3200	3300	4000	3300
P-15249	0.875	3100	3300	1600	2200	2000	2200
P-15275	6.099	6600	3300	4900	3300	6100	3300
P-15965	1.634	2900	3300	1800	2500	2300	3000
P-16315	5.805	4500	3300	3300	3300	4100	3300
P-17143	2.638	3000	3300	2000	2600	2400	3300
P-18818	2.70	3500	3300	2300	3200	2900	3300
P-18289	0.23	1100	1500	500	700	700	900
P-19031	5.997	5700	3300	4500	3300	5700	3300
P-19574	2.651	4800	3300	3300	3300	4100	3300
P-21083	4.749	3000	3300	2100	2800	2600	3300
P-22071	2.319	4100	3300	2600	3300	3200	3300

Säleiprofilien maksimi toimitus/käyttöpituus 6600 mm.

* Maksimi säleen jänneväli 1-aukkoiset rakenteet (rakennemalli, jossa säle tuetaan/kiinnitetään päistään kahdesta pisteestä).

-> säleiden maksimi jänneväli taulukon mukaan.

* Maksimi säleen jänneväli 2-aukkoiset rakenteet (rakennemalli, jossa säle tuetaan/kiinnitetään päistään kahdesta pisteestä sekä kolmannesta pisteestä säleen keskeltä).

-> säleiden maksimijänneväli taulukosta (kun maksimi jänneväli 3300 mm, rajoitteena max. profiilimitta L/2.)

The maximum use of length/ delivery length for lamella profiles is 6600 mm.

* 1-span-beams, louvre blades maximum span dimension from table

* 2-span-beams, louvre blades maximum span dimension from table (max. span 3300 mm caused by max profile length L/2.)

1-aukkoinen päistä tuettu rakenne.
1-span beam.

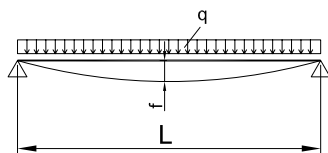

2-aukkoinen päistä ja keskeltä tuettu rakenne.
2-span beam.

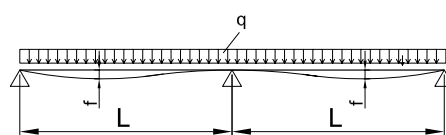

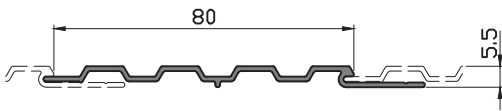

P-11666

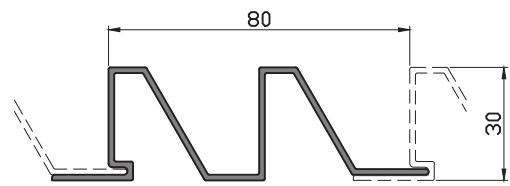

P-5461

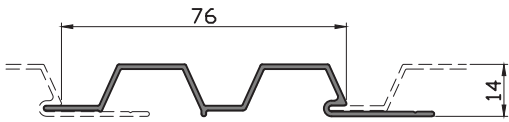

P-11665

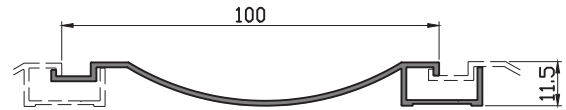

P-1689

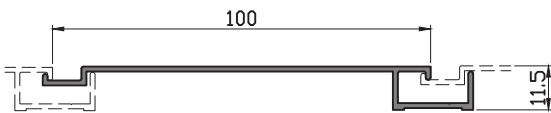

P-409

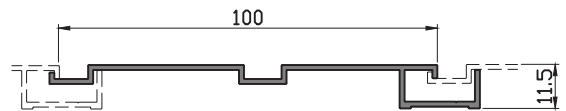

P-1872

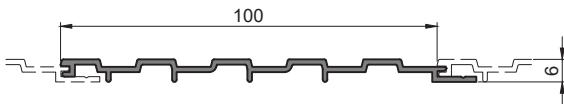

P-20567

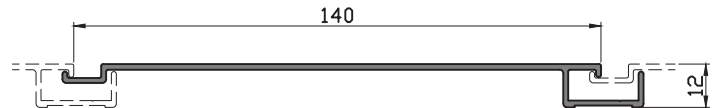

P-12078

Väilista
Intermediate strip

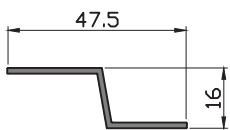

P-420

Aloituslista
Starting strip

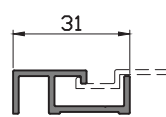

P-410

Päätöslista
Ending strip



P-411

Ulkokulma
Outer angle

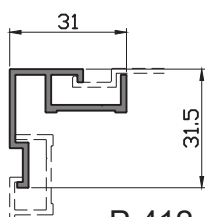

P-412

Pystyjatkos
Vertical extensions

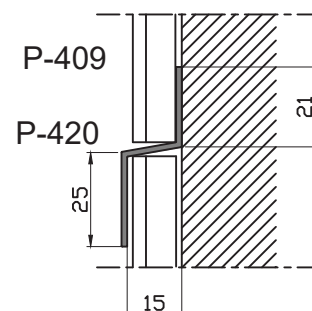

ALLINE on alumiiniprofileista koottu sisäkattojärjestelmä. ALLINESSA yhdistyvät muodon täsmällisyys, korkea laatu ja monipuoliset pintakäsittelymahdollisuudet anodisoinnista pulverimaalaukseen.

ALLINE on edustava ja kovat vaatimukset täyttävä sisäkatto. Muoto ja väri säilyvät kovissakin olosuhteissa.

ALLINE -sisäkattojärjestelmän etuna on joustava muotojen ja nittojen valintamahdollisuus. ALLINE järjestelmään arkkitehti voi suunnitella myös täysin yksilöllisen sälemuodon kohteen omaleimaisuutta korostamaan.

ALLINE-kannatuskiskot ripustetaan kannatuslankojen varaan. Kiskojen korkeussäätö on portaaton. Säleet painetaan halutuun välein kiskoihin

ALLINE system gives individual look for indoor ceilings. ALLINE system can be designed and modified according to customer needs and it's easy to install. Surface treatment: anodizing, powder coating.

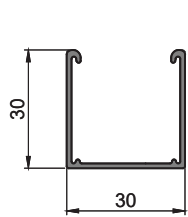
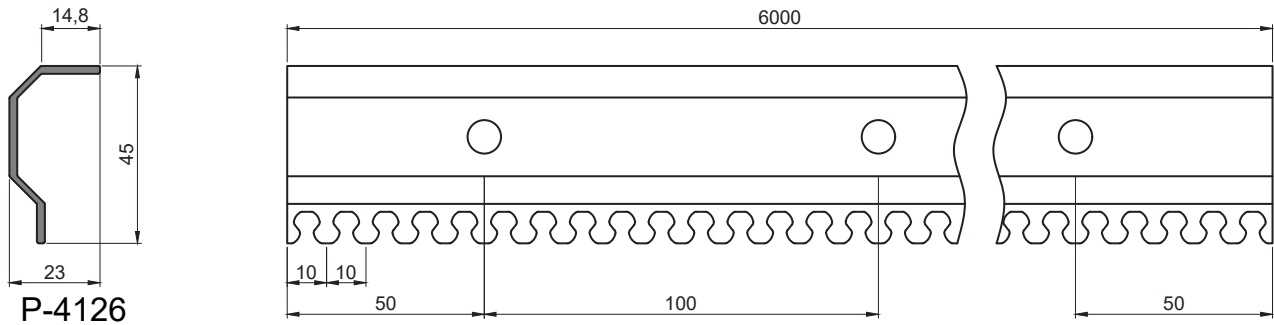

P-18384

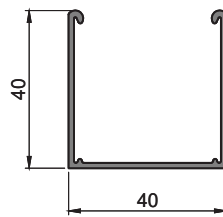

P-5283

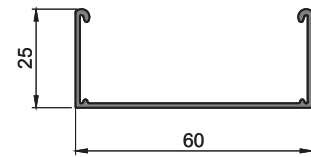

P-4102

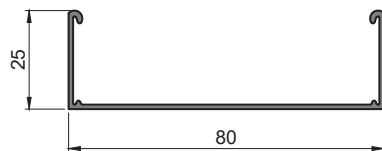

P-4103

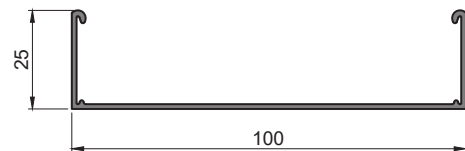

P-4104

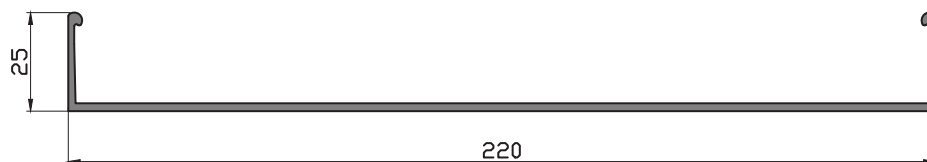

P-10707

Jatkopala 25 mm korkeille profileille
Joint piece for 25 mm high profiles



JATKO1

Jatkopala 30 mm korkeille profileille
Joint piece for 30 mm high profiles

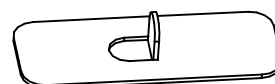

JATKO3

Profilit

- alumiiniseos yleensä EN-AW 6063 T5

$$R_{p0,2} \text{ min} = 130 \text{ N/mm}^2$$

$$R_m \text{ min} = 175 \text{ N/mm}^2$$

$$E = 70000 \text{ N/mm}^2$$

- alumiinirakenteiden suunnittelussa on otettava huomioon lämpötilan muutoksista aiheutuvat siirtymät
- alumiinin lämpölaajenemiskerroin on $24 \times 10^{-6}/K$
- profiilien muototoleranssit EN 755-9 tai EN 12020-2 mukaan
- seos soveltuu erinomaisesti anodisoitavaksi
- toimituspituus on normaalisti 6,6 m, muut mitat erikoistilauksesta

Profiilien pintakäsittely

Anodisointi

Anodisointi on sähkökemiallinen menetelmä, jolla kasvatetaan alumiinin luonnollisen oksidikerroksen paksuutta. Anodisointi muodostaa kovan, mekaanista kulutusta kestävä pinnan, jolla on erinomainen säänkesto.

Jauhemaalaus

Jauhemaalauksessa profiilin pintaan ruiskutetaan pulveri, joka sulatetaan uunissa kestäväksi ja tasaiseksi pinnaksi. Ennen maalausta profiileille tehdään esikäsitteily, jolla varmistetaan maalin pysyvyys. Normaalisti käytetään RAL-värikartan sävyjä, mutta muutkin sävyt ovat mahdollisia.

TECHNICAL INFORMATION

Profiles

- Aluminium alloy usually EN-AW 6063 T5

$$R_{p0,2} \text{ min} = 130 \text{ N/mm}^2$$

$$R_m \text{ min} = 175 \text{ N/mm}^2$$

$$E = 70000 \text{ N/mm}^2$$

- Thermal transitions caused by changes in temperature must be taken into account in the design
- Thermal expansion coefficient of aluminium is $24 \times 10^{-6}/K$
- Shape tolerances of profiles according to EN 755-9 or EN 12020-2
- Alloy is well suited for anodizing
- Delivery length of profiles normally 6,6m, other lengths available on request

Surface treatment

Anodizing

Anodizing is an electrochemical method for increasing the thickness of the natural oxide layer of aluminium. Anodizing forms a hard, mechanical wear-resistant surface with excellent weather resistance.

Powder Coating

In powder coating the powder is injected into the surface of the profiles, which then is melted in a furnace into a durable and smooth surface. Before painting, the profiles are pre-processed, in order to ensure the endurance of the coating. Normally profiles are painted with RAL color shades, but other colors are also possible.



Valmistus, myynti ja tekninen neuvonta
Manufacturing, sales and technical information

Purso Oy
Rakennusjärjestelmät
Building Systems Unit
Alumiinitie 1, FI-37200 Siuro, Finland

Tel. +358 3 3404 111, fax +358 3 3404 500

purso@purso.fi
www.pursobuilding.fi

Pidätämme oikeuden muutoksiin ilman erillistä ilmoitusta.
All rights reserved without prior notice.

Copyright © Purso Oy

